

# TSE 3004 Wireless



Made in Germany  
[www.burg-waechter.de](http://www.burg-waechter.de)

## Montageanleitung

Assembly instruction

Instructions de montage



2x M4 x 9

4x M4 x 20

6x 2,9 x 13

1x 2,9 x 16

1x 2,9 x 22

2x 3,9 x 22

4x 3,9 x 12

1x 2,9 x 9,5

4x M2 x 10

1x M5 x 80

4

3

2

1

**Innenseite der Tür!**  
**Inside the door!**  
**Côté intérieur**  
**de la porte!**

**Aussenseite der Tür!**  
**Outside the door!**  
**Côté extérieur**  
**de la porte!**

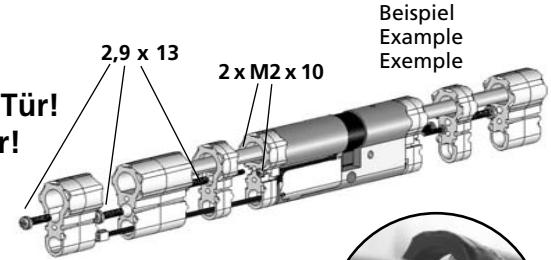

Beispiel  
Example  
Exemple

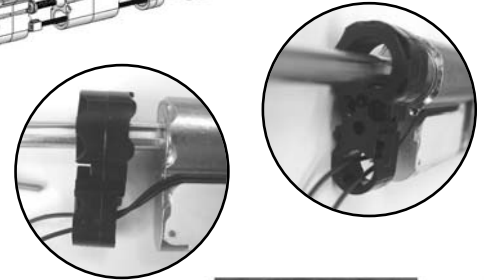

4	3	2	1	a
28mm	18mm	8mm	9mm	(mm)
			X	17 - 25
			X	26 - 33
		X	X	34 - 43
	X		X	44 - 53
X			X	54 - 62
X		X	X	63 - 65

b	1	2	3		
(mm)	9mm	8mm	18mm		
17 - 21				X	X
22 - 30	X			X	X
31 - 38	X	X		X	X
39 - 49	X			X	X
50 - 53	X		X		X
54 - 62	X	X			X
63 - 65	X		X		X

○  
Zylinderlochung Tür  
Cylinder boring door  
Perforation cylindrique  
de la porte

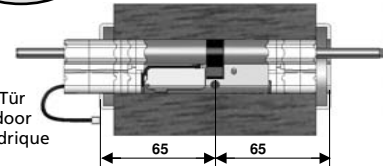

Seite 4,5  
page 4,5  
page 4,5

Seite 4,6  
page 4,6  
page 4,6

Seite 4,7  
page 4,7  
page 4,7

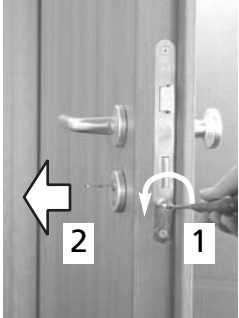

Innenseite  
der Tür!  
Inside the  
door!  
Côté  
intérieur de  
la porte!



Aussenseite  
der Tür!  
Outside the  
door!  
Côté extérieur  
de la porte!



Funktionstest  
Function test  
Test de fonctions

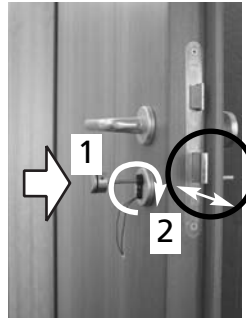

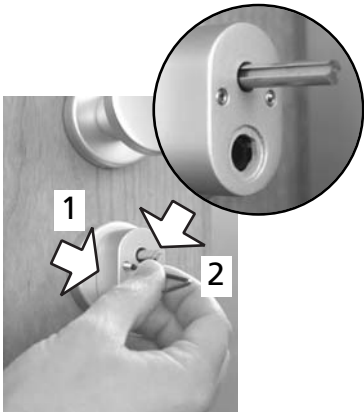



2 x  M4x20



 M4 x 9





  2,9 x 16  
oder/or/ou  
x 22

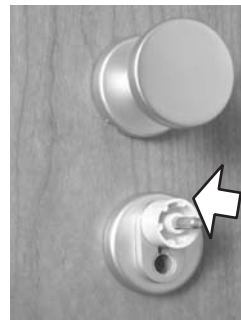

  M4 x 9



OK

→ Seite 8 page 8 page 8

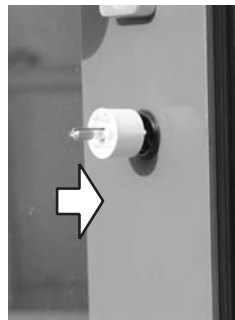
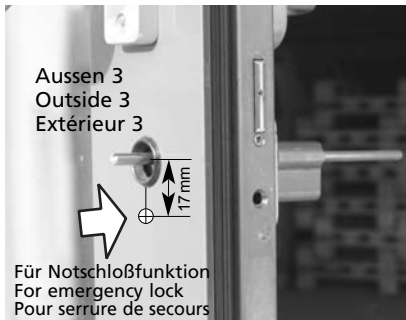

Innenseite  
der Tür!  
Inside the  
door!  
Côté  
intérieur de  
la porte!

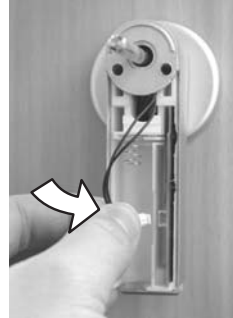





2x 1,5V AA

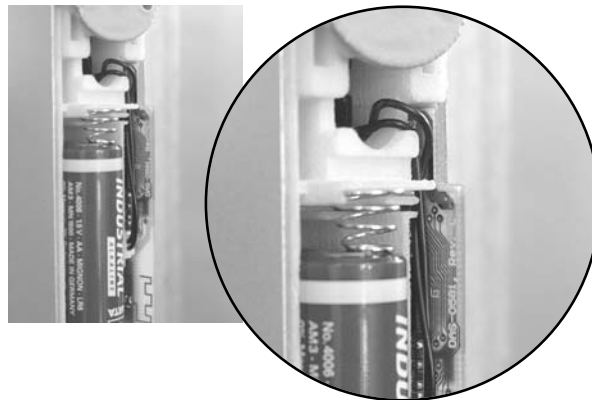



 2,9x9,5







 2xM4x20



 M4x9



OK



oder/or/ou

Oberflächen fettfrei  
Surfaces free of  
grease  
Surface exempté  
de graisse

4 x  kleben  
adhesive  
coller



4 x  Ø 2,9

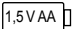

2 x 





**BURG-WÄCHTER KG**

Altenhofer Weg 15  
D - 58300 Wetter  
Germany

[www.burg-waechter.de](http://www.burg-waechter.de)  
[info@burg-waechter.de](mailto:info@burg-waechter.de)

TSE 3004 Wireless  
Montageanleitung



Irrtum und Änderungen vorbehalten  
Omissions and changes reserved  
Sous réserve de fautes d'erreurs et  
de modifications