



secu **ENTRY**

Operating instructions secuENTRY KeyApp

iOS version
English

en



BURG-WÄCHTER KG
Altenhofer Weg 15
58300 Wetter
Germany

BURG-WÄCHTER UK LTD
Eurocam Technology Park
Chase Way, Bradford, West Yorkshire
England BD5 8 HW

www.burg.biz

Contents index

Description	2
1 Download and install the secuENTRY KeyApp	2
2 Setting up the secuENTRY KeyApp	2
3 How is a lock registered in the secuENTRY KeyApp?	4
4 Open with the secuENTRY KeyApp	4
5 Functions	5
5.1 secuENTRY E-Key	5
5.1.1 Manuel registration	5
5.1.2 E-Key functions	6
5.1.3 secuENTRY units	10
5.2 secuENTRY Bridge	11
5.2.1 Log in/ Registration	12
5.2.2 Family	14
5.2.3 secuENTRY Bridge & assignments	17
5.2.4 Access codes	18
5.3 Video Bell	20
5.3.1 Log in/ Registration	21
5.3.2 Family	23
5.3.3 Video Bell units & assignments	26
5.3.4 Video Bell display	29
5.3.5 Firmware update	30
5.3.6 Direct access button	30
5.4 BURGcam	30
5.4.1 Login / create an account	31
5.4.2 Family	33
5.4.3 BURGcam units & assignments	36
5.4.4 BURGcam display	39
5.4.5 Firmware update	40
5.4.6 Direct access button	40
5.5 eBoxx	40
5.5.1 eBoxx settings	41
5.5.2 Account settings	43
5.5.3 Direct access button	48
5.6 Config file PC software	49
5.6.1 Import config files	49
5.6.2 Readout history	50
5.6.3 Display history	50
5.6.4 Remove history	51
5.6.5 Program lock	51
5.6.6 Remove config files	51
5.7 History	52
5.7.1 Readout history	52
5.7.2 Lock history	53
5.7.3 KeyApp history	54
5.8 Firmware update	54
5.9 Settings	55
5.9.1 Password	56
5.9.2 Administrator code	56
5.9.3 I want to help	56
5.9.4 Info	56

Description

The KeyApp from BURG-WÄCHTER allows another option to open / lock locks of the secuENTRY series. In addition to the unlocking media already known, such as Pincode, Fingerprint or Passive transponder, now there is also the option of unlocking the lock per KeyApp using a smartphone. You can even open your locks via the Internet with our secuENTRY 5670 Bridge module.

After the identification features of the app user are sent to the administrator or owner of the locking system, these can be taken over in the user management of the exclusive secuENTRY PC software. The application can very easily be stored as opening media for the respective locks. If required, the KeyApp can also be registered manually by scanning in the QR code on the locks to which access should be permitted. After the programming or manual registration of the locks, the respective locks can then be operated actively using the smartphone.

In addition to this unlocking method, there is also the possibility to enable the KeyLess Entry function for individual locks. For this purpose, a period can be defined for all locks registered in which an automatic unlocking takes place as soon as the smartphone is in the detection range of the lock. The KeyLess Entry function is highly dependent on the physical ambient conditions as well as the smart device used and the corresponding operating system version, meaning access time may vary considerably.

The secuENTRY 5670 Bridge allows you to open your lock conveniently from a long distance. An internet connection is required for both the smart device and the bridge. It is also possible to allocate time-limited access codes. For increased security, we use 2-factor authentication for allocating the access codes.

Additional other devices such as the DOOR eGuard Video Bell DG8500 video intercom and the BURGCam LIGHT 3010 WLAN camera can be also integrated into the app. This enables functions such as the recording of photos or videos - directly in the KeyApp. The KeyApp can also be used to set up the BURG-WÄCHTER eBoxx EASY+ parcel box. This means you can open and configure the eBoxx, for example, and then use it to receive parcels.

The app was tested using Apple iPhone 4S, 5, 5S, 6, 6P, 6S, 6SP, 7 from iOS 8.1.3

Please check in the application description which other smart devices can be used with the application.

1. Download and install the secuENTRY KeyApp

When entering the search term "secuENTRY" and / or "KeyApp" in the Apple App Store, you are taken directly to the download area of the app. Here you can select and install the KeyApp.

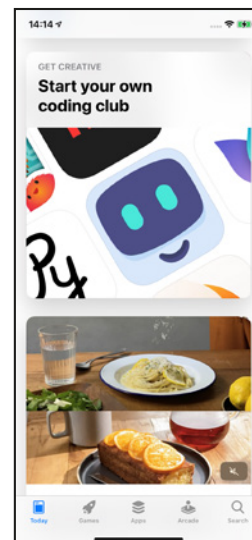

Fig. 1

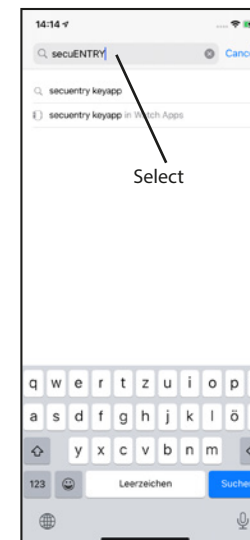

Fig. 2

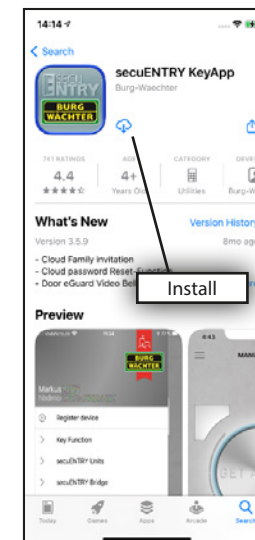

Fig. 3

2. Setting up the secuENTRY KeyApp

You will be asked to read and confirm the licence conditions when you open the KeyApp for the first time (see figure 1).

Then you are prompted to register the locking system at the administrator. If you are the owner or administrator of the locking system yourself, this could be your own address. The administrator therefore has the overview of the media with opening authorisation. Enter the respective data for this purpose and select "Register".

Accept the terms

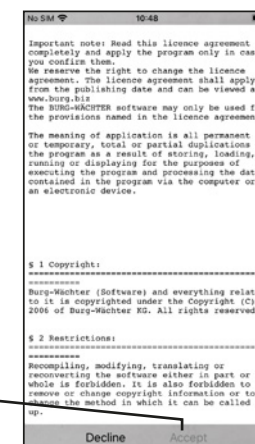

Fig. 1

Here, enter your first name as well as last name and your personal e-mail address (do not use any empty spaces!)

Enter the e-mail address of the locking system administrator here

Select whether you...

- wish to set up a BW Cloud account
- wish to receive automatic information about updates
- wish to receive the BW Newsletter

Read and accept the linked documents

Press "Complete" to register

Press the send button to send the data to your administrator.

Fig. 2

Fig. 3

If you already have a BW Cloud Account, you can login as usual. If you have specified that you do not want to use the BW Cloud in the previous menu, you can still connect to this at a later time. In both cases, you can skip the following steps.

Fig. 4

Fig. 5

Fig. 6

Fig. 7

Click on this button to access for registration.

Choose a password and enter it.

Press the button to receive a verification code per e-mail

Enter the 6 digit verification code that you have received per e-mail.

Press the button to complete the registration

You have successfully registered and logged in.

You can then choose whether you want to send anonymised data to BURG-WÄCHTER so that the KeyApp can be improved. You can change your decision later if you wish.

The KeyApp is now ready for use. For the full scope of the functions, a (one-off) authorisation must be issued. This is queried when necessary.

3. How is a lock registered in the secuENTRY KeyApp?



Fig. 1

Press the Menu button

Press the "E-Key" button

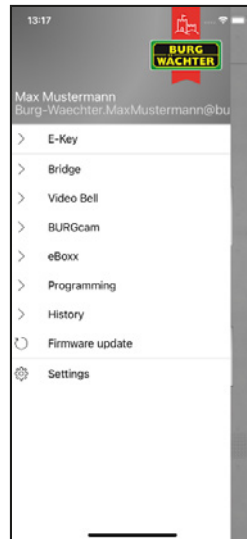

Fig. 2

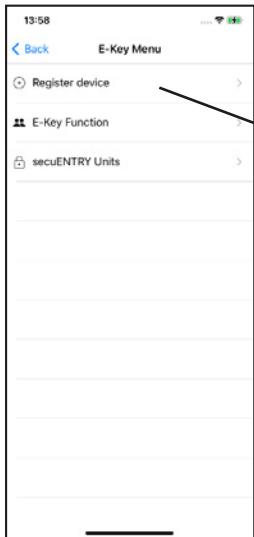

Fig. 3

Select "Register device"

The camera opens.
Scan the QR code of your device



Fig. 4

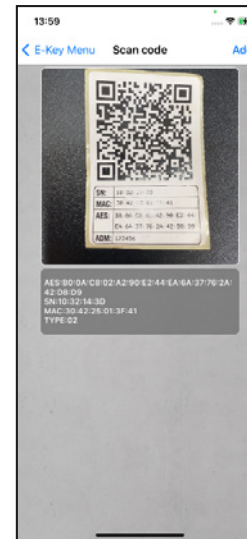

Fig. 5

Press the "Add" button

Enter the name for the device and corresponding administrator code. Press the "START PROCESS" button.

The KeyApp is registered in the lock after a short period. Press the "OK" button.



Fig. 6

4. Open with the secuENTRY KeyApp

Using the "GET ACCESS" button, now the lock can be actuated. For this purpose, hold the smartphone in front of the lock and press the button.

If the transmission is successful, you can then turn the rotary knob of the lock respectively open your parcel box. The 4 buttons that are arranged around the "GET ACCESS" button can also be used to open locks.

For more information, see the chapter "Direct access buttons". The "GET ACCESS" button opens the lock which has the least distance to the smartphone.

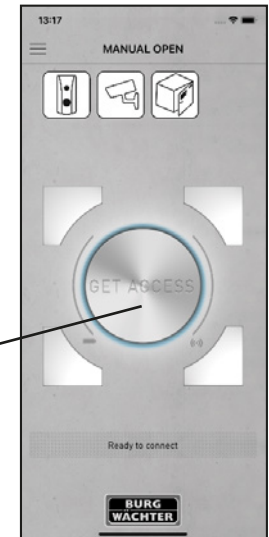

Fig. 1

Press to open

5. Functions

This section gives you a description of the various functions.

5.1 secuENTRY E-Key

The E-Key menu contains functions for using secuENTRY profile cylinders.

Note: The "Manual registration" and the "Direct access buttons" can also be used for the BURG-WÄCHTER eBoxx EASY+ parcel box.



Fig. 1

Press the Menu button

Press the "E-Key" button

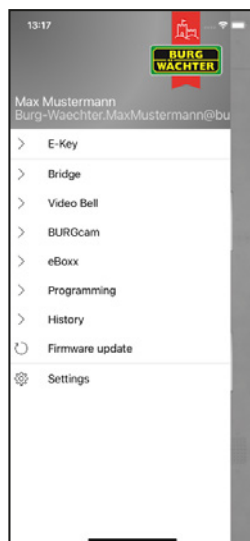

Fig. 2

5.1.1 Manuel registration

Manually registered locks and eBoxxes can be opened via the "GET ACCESS" button.



Fig. 1

Select "Register device"

The camera opens.
Scan the QR code of your device



Fig. 2

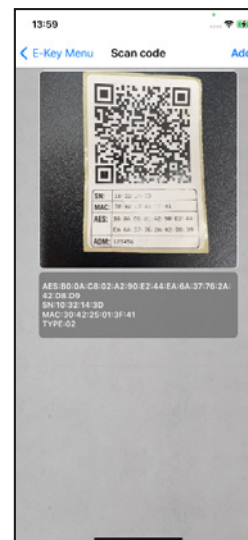

Fig. 3

Press the "Add" button

Enter the name for the device
and corresponding administrator
code. Press the "START PROCESS"
button.

The KeyApp is registered in the
lock after a short period. Press
the "OK" button.



Fig. 4

5.1.2 E-Key functions

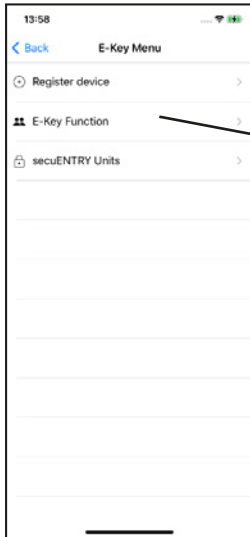

Fig. 1

5.1.2.1 Send again

Send the registration data of the app to the locking system administrator again.

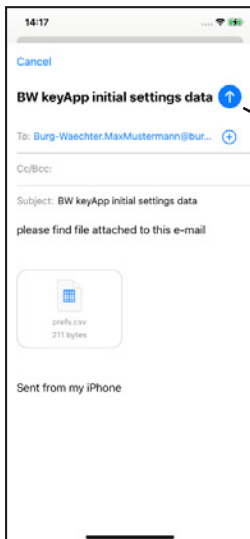

Fig. 1

5.1.2.2 KeyLess

The KeyLess Entry function allows the locks assigned under "secuENTRY list" to be opened automatically without having to press the "GET ACCESS" button again, or use another opening secret (Pincode, Fingerprint or Transponder). For this purpose, under "secuENTRY list" you have to set which known locks should be opened in this manner. As soon as the registered smartphone is within the area of detection, the lock is opened automatically.

Attention: the response time until releasing for opening the lock differs from smartphone to smartphone and cannot be modified. The function also depends on the WLAN network as well as the hardware and software of the respective manufacturer. The response time is independent of the app!



Fig. 1



Fig. 2

Activate the function

The sub-functions that appeared during activation are described on the following pages.

Home WLAN detection:

Selection of the WLAN network that should be used for communication. After opening one time, the system is KeyLess active for 3 minutes. Thus the lock opens automatically within 3 minutes as soon as it is within the reception range and the system has been detected. Then the KeyLess function deactivates again.



Fig. 1

- Activate the function
- Select your own WLAN network
- Press the button

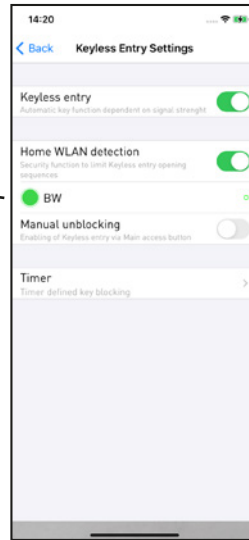

Fig. 2

Timer:

Under this menu, you can setup the time window where the KeyLess Entry is activated. Deviating from this time, the KeyLess Entry function is inactive. If no timer has been defined, the KeyLess Entry function is active permanently without time limitation.

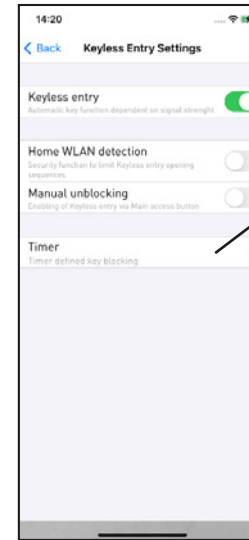

Fig. 1

- Timer function
- Add a new timer

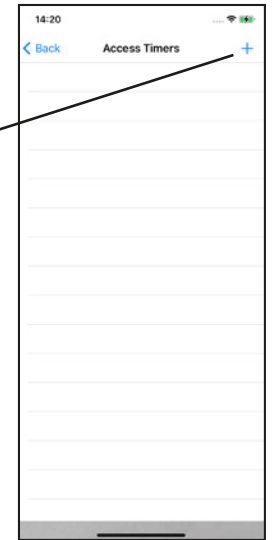

Fig. 2

Manual unlocking:

For manual unlocking, the lock must be opened one time via the "GET ACCESS" button before the function is activated. Then it remains active until the respective smartphone has activated the KeyLess Entry function once and the lock has been opened.

- Activate the function

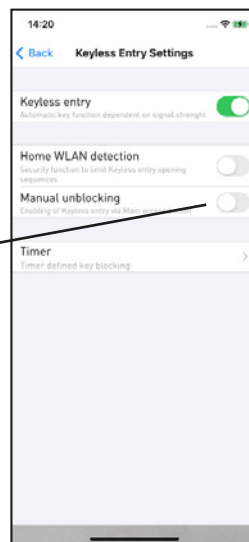

Fig. 3

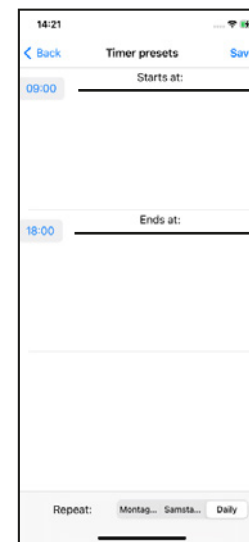

Fig. 3

- Select the start time
- Select the end time
- Select the days
- Swipe to the left to delete a timer

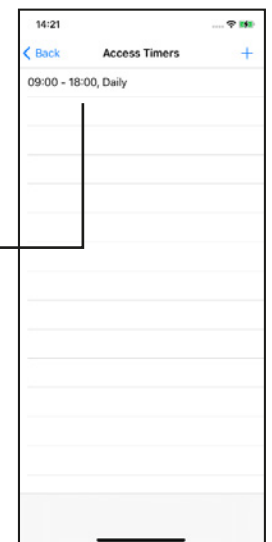

Fig. 4

5.1.2.3 secuENTRY list

All known locks are displayed in the WHITE list. Here you can decide if the "KeyLess Entry" function should be activated for each lock. The locks can also be renamed.

Activate KeyLess Entry:



Fig. 1

Activate the function

Rename lock

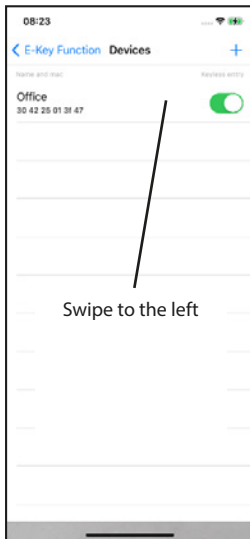

Fig. 1

Swipe to the left



Fig. 2

Edit

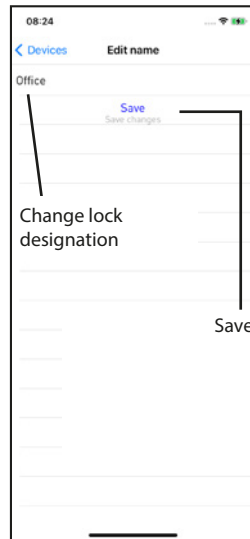

Fig. 3

Change lock designation

Save

Add lock

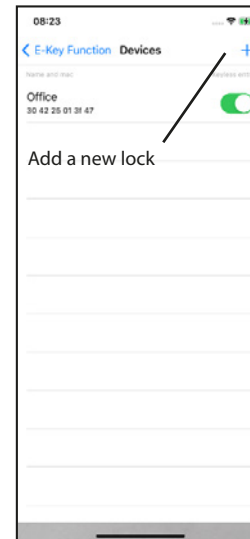

Fig. 1

Add a new lock

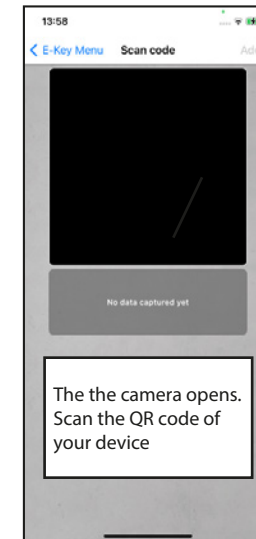

Fig. 2

The the camera opens.
Scan the QR code of
your device



Fig. 3

Press the "Add"
button

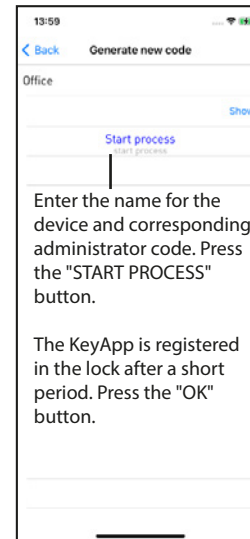

Fig. 4

Enter the name for the
device and corresponding
administrator code. Press
the "START PROCESS"
button.

The KeyApp is registered
in the lock after a short
period. Press the "OK"
button.

Remove lock

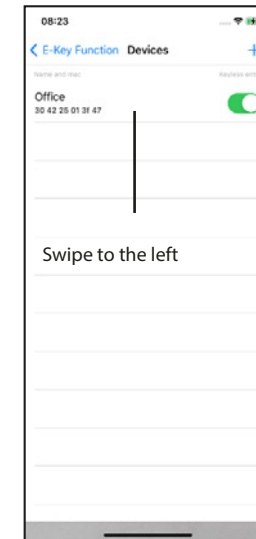

Fig. 1

Swipe to the left

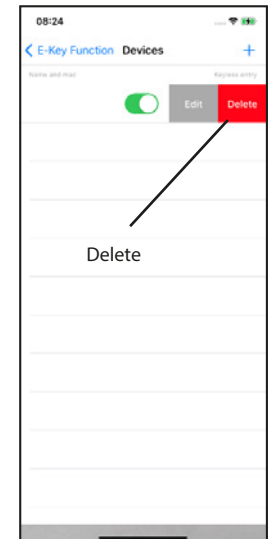

Fig. 2

Delete

5.1.2.4 Direct access buttons

The direct access buttons can be allocated in order to allow a lock to be opened from the start screen. New locks can also be added.

Assign direct access keys:



Fig. 1

Choose a lock

Choose one of the buttons.
Then confirm with "OK"

As an alternative, a direct access button that has not been assigned on the start screen can be pressed to open the menu.

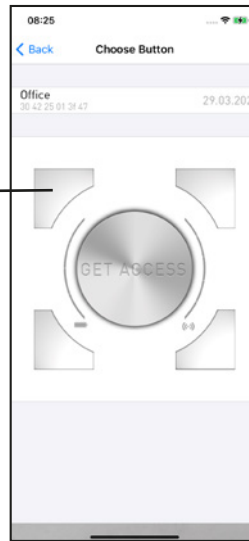

Fig. 2

Add a lock:



Fig. 1

Add a new lock

The the camera opens. Scan the QR code of your device

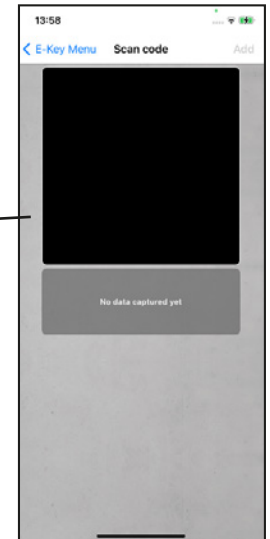

Fig. 2

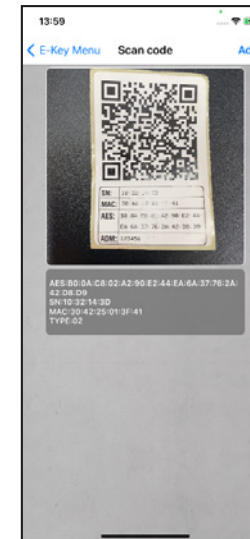

Fig. 3

Press the "Add" button

Enter the name for the device and corresponding administrator code. Press the "START PROCESS" button.

The KeyApp is registered in the lock after a short period. Press the "OK" button.

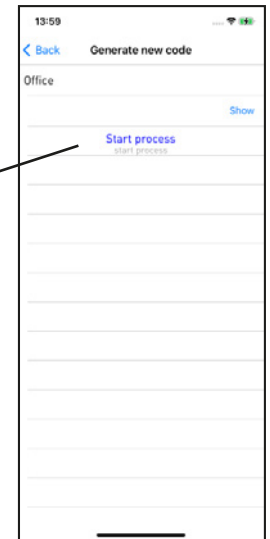

Fig. 4

5.1.3 secuENTRY units

The direct access buttons can be allocated in order to allow a lock to be opened from the start screen. New locks can also be added.



Fig. 1

This menu offers 3 functions. Set which locks should be controlled via a bridge, allocate buttons to the locks and add new locks.

Activate the Bridge function:

Locks that are contacted via a bridge are contacted by WLAN instead of Bluetooth. As a result, the opening takes a little longer, but you are able to open the lock from everywhere as long as you have an internet connection.

Open using a bridge



Fig. 2

Connect the keypad:

A lock can also be connected with a keypad in the app.

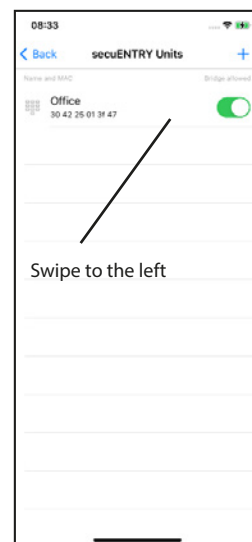

Fig. 1

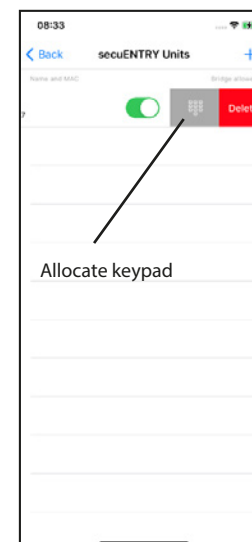

Fig. 2

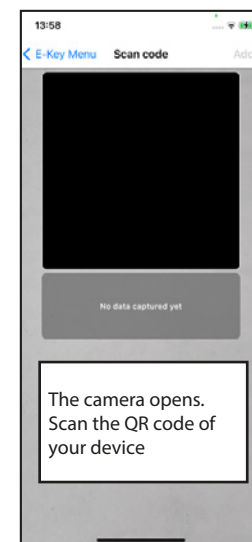

Fig. 2

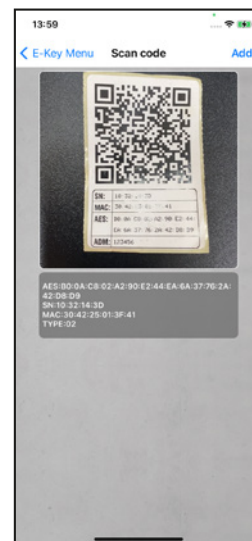

Fig. 3

Press the "Add" button

When tapping on one of the locks, you can see the keypads logged onto the lock.

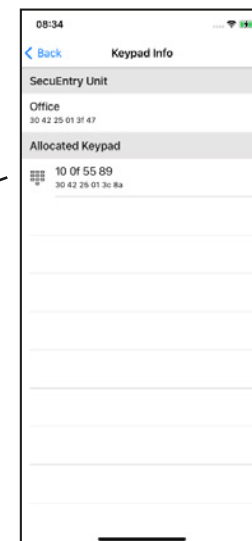

Fig. 4

Add a lock:



Fig. 1



Fig. 2

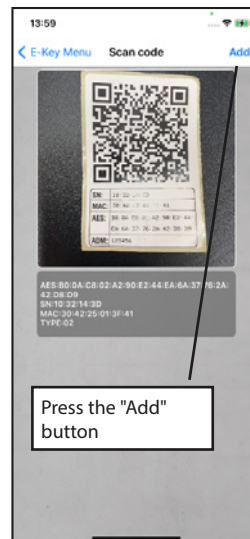

Fig. 3



Fig. 4

Enter the name for the device and corresponding administrator code. Press the "START PROCESS" button.

The KeyApp is registered in the lock after a short period. Press the "OK" button.

Swipe to the left to delete

Remove lock:



Fig. 1

5.2 secuENTRY Bridge

Locks that are contacted via a bridge are contacted by WLAN instead of Bluetooth. As a result, the opening takes a little longer, but you are able to open the lock from everywhere as long as you have an internet connection. Each bridge can only be connected to one lock. Locks that are connected via one bridge can also be programmed via this, and receive codes that have been entered via the keypad.

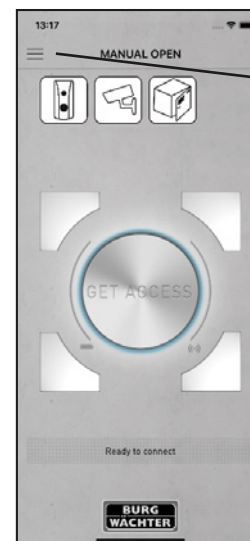

Fig. 1

Press the Menu button

Press the "Bridge" button

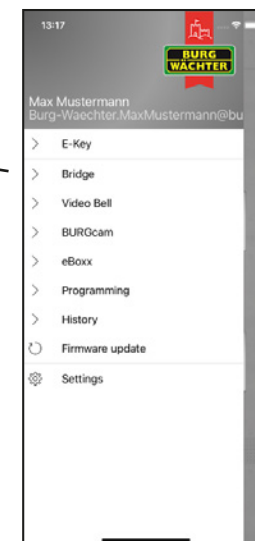

Fig. 2

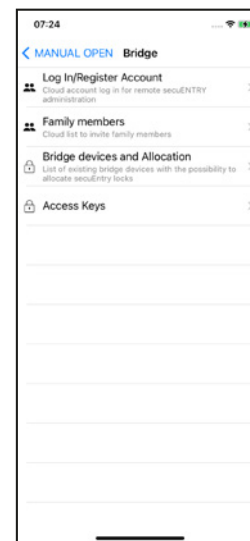

Fig. 3

5.2.1 Log in/ Registration

If you have made a decision for a Cloud Account during setup and have not logged out since then, you can skip this step. Otherwise you will have to login or create a new account.

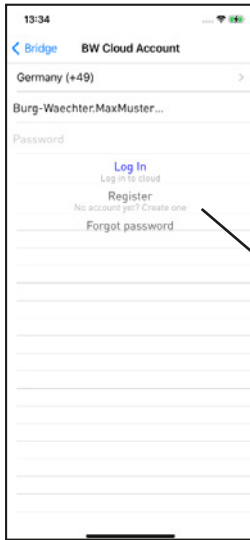

Fig. 4

Click on this button to access for registration.

Choose a password and enter it.

Press the button to receive a verification code per e-mail



Fig. 5



Fig. 6

Enter the 6 digit verification code that you have received per e-mail.

Press the button to complete the registration

You have successfully registered and logged in.



Fig. 7

Log in:

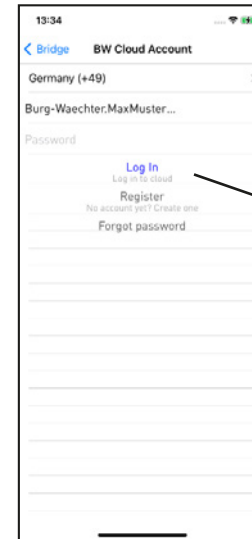

Fig. 1

Enter your password and press the button

You have successfully logged in.



Fig. 2

Log out:



Fig. 1

Press this button

Change password:

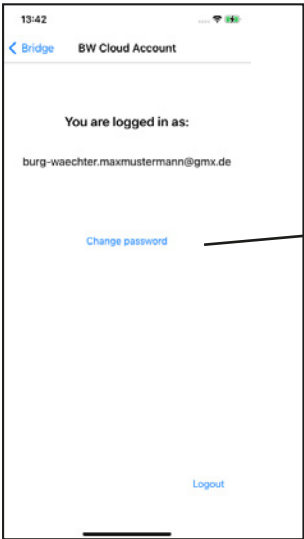

Fig. 1

Press this button

Enter the 6 digit verification code that you have received per e-mail and press the button.

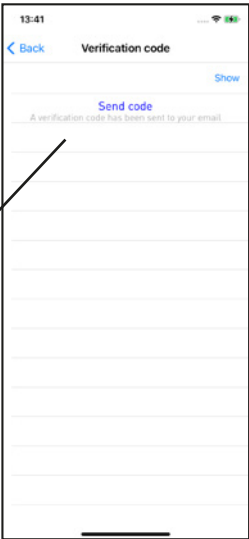

Fig. 2

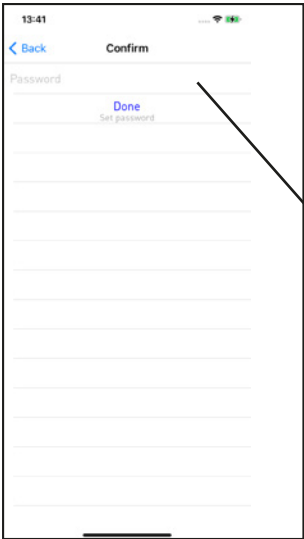

Fig. 3

Enter your new password. Press the command button

Press this button



Fig. 4

Recover password:

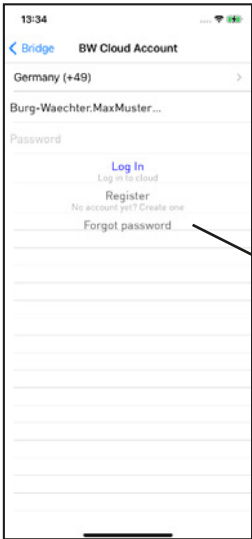

Fig. 1

Press this button

Enter your email address and press the button



Fig. 2



Fig. 3

Enter the 6 digit verification code that you have received per e-mail and press the button.

Enter your new password. Press the command button



Fig. 4

5.2.2 Family

The Family functions make it easy for families to set up Bridges, BURGcams and Video Bells. The devices must be set up just once by the family administrator. The administrator must then add a family group and invite the rest of the family members to it. Once the invitations have been accepted, the devices are available to all family members.

Add family group:

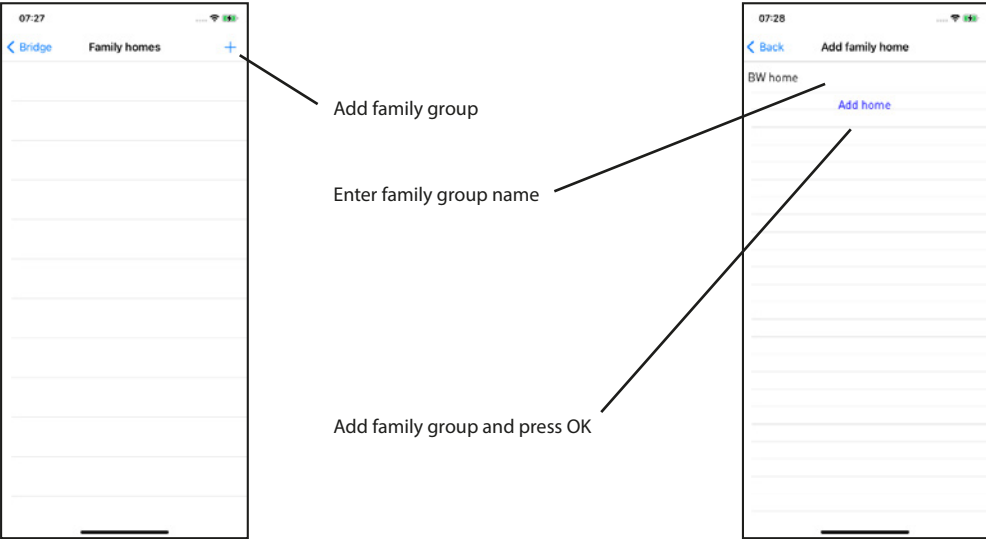

Fig. 1

Fig. 2

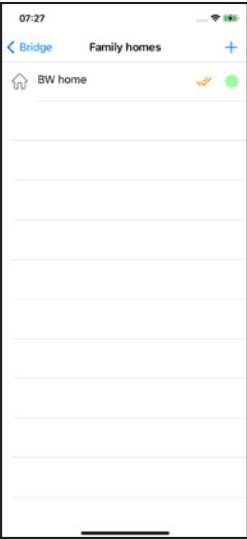

Fig. 3

Activate family group:

If several family groups are entered, one of them must be marked as the currently active group. The active group is displayed with the double tick. Access is available to the devices of the active family group.

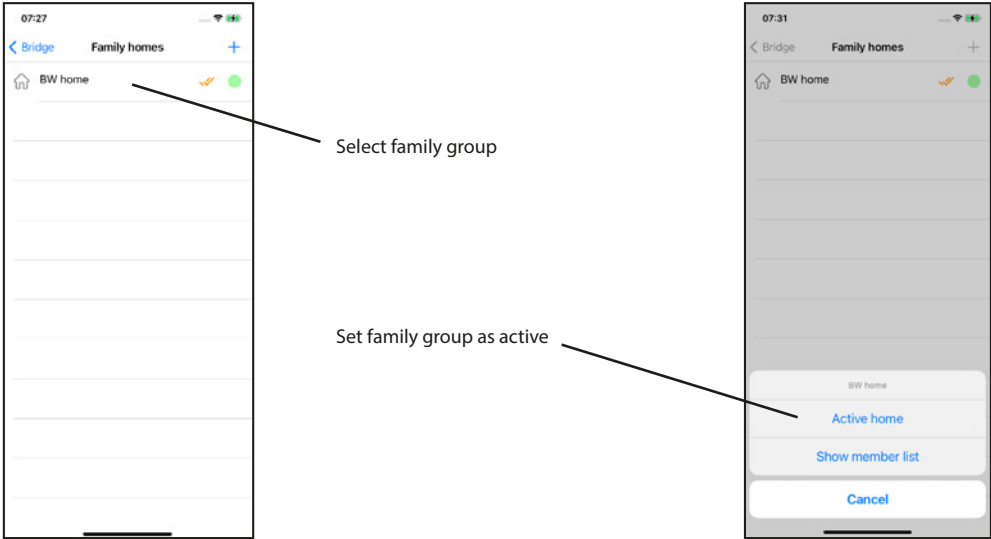

Fig. 1

Fig. 2

Delete family group:

Family groups cannot be deleted. Only the connection between cloud accounts and family groups can be removed.

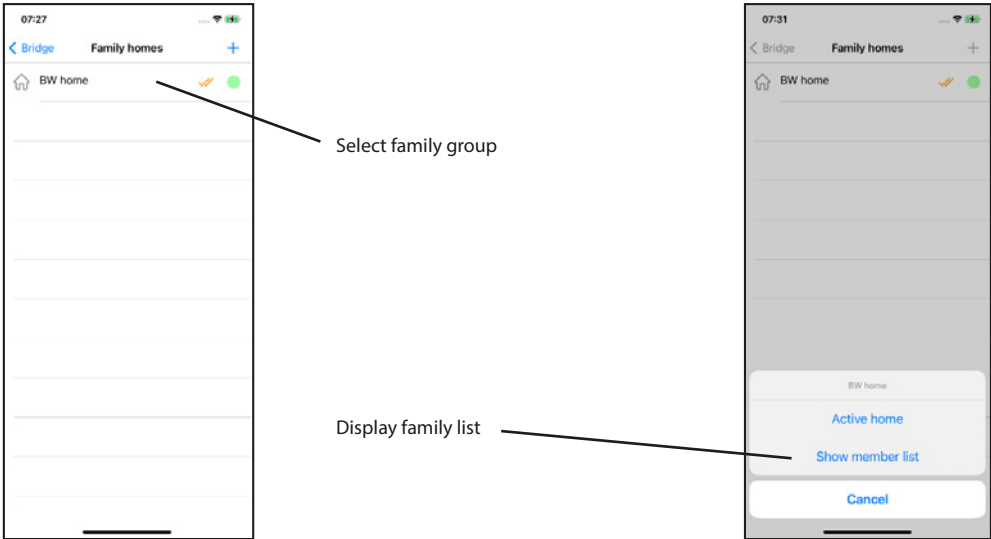

Fig. 1

Fig. 2



Fig. 3

Swipe your own name to the left to disconnect. The family group will then no longer be displayed.



Fig. 4

Add family members:

Family members can only be added by the family administrator.



Fig. 1

Select family group

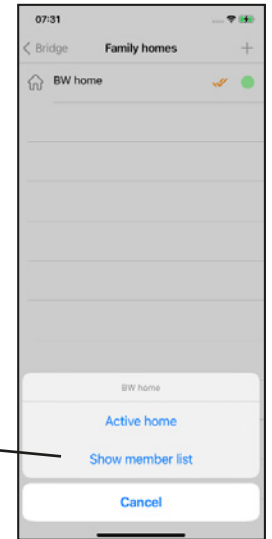

Fig. 2

Display family list

Display family members:

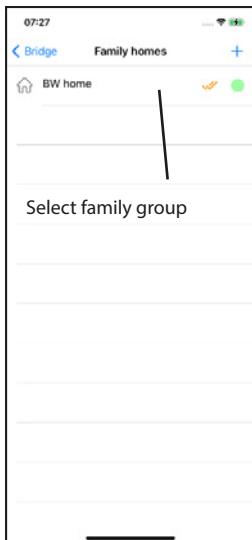

Fig. 1



Fig. 2

Display family list



Fig. 3



Fig. 3

Add family member

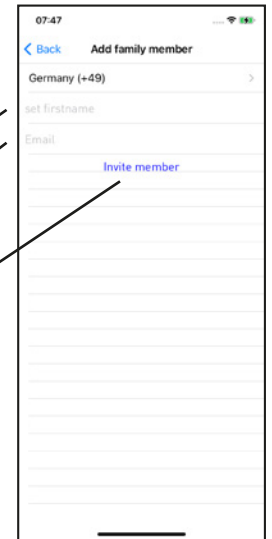

Fig. 4

Name of the family member

Email address of the family member

Send invitation and press OK

An invitation that has been sent must first be accepted by the other family member before this member becomes part of the family group. Invitations that have not yet been accepted are marked with a yellow icon next to the name. These steps must be performed on the invited family member's smartphone.

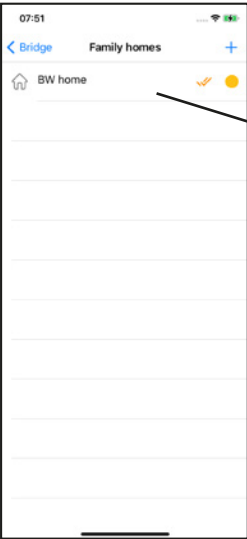

Fig. 1

Click on the invitation to the family group

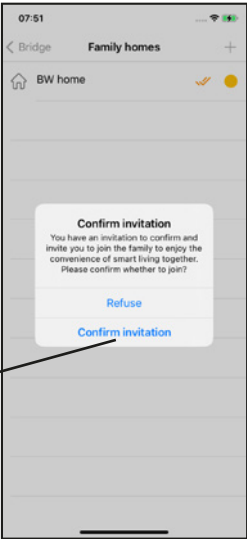

Fig. 2

Accept invitation

Remove family members:



Fig. 1

Select family group

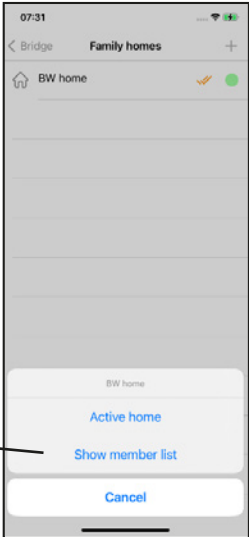

Fig. 2

Display family list



Fig. 3

Swipe the name of the family member to be removed to the left



Fig. 4

5.2.3 secuENTRY Bridge & assignments

Add secuENTRY Bridge:

Supply the secuENTRY Bridge with power by inserting the USB cable.
Keep the Reset button pressed for 5 seconds. The green LED starts to flash.



Fig. 1

Add a Bridge

Enter a name for the Bridge

Enter the password for
your WLAN network

Press this button

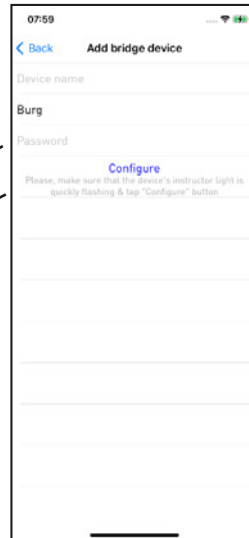

Fig. 2



Fig. 3

Allocate a lock:



Fig. 1

Choose a Bridge

Search for locks nearby

View locks in the WHITE list



Fig. 2



Fig. 3

Choose a lock

Display assigned locks:



Fig. 1



Fig. 2



Fig. 3

Remove Bridge:

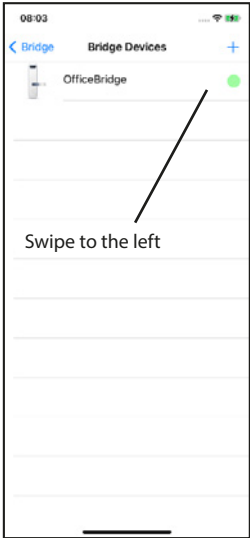

Fig. 1

Remove assigned locks:



Fig. 1



Fig. 2

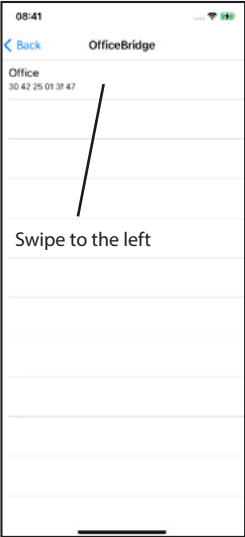

Fig. 3

5.2.4 Access codes

Locks that are contacted per Bridge may also contain access codes limited by time. In doing so however, it is important that these are also activated in the chronological order. One-time access keys are also possible in the future.

Create an access code:

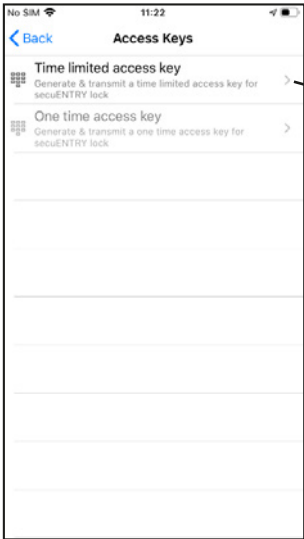

Fig. 1

Choose a function

Create a time limited key

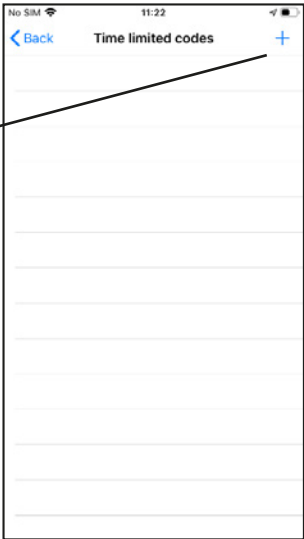

Fig. 2



Fig. 3

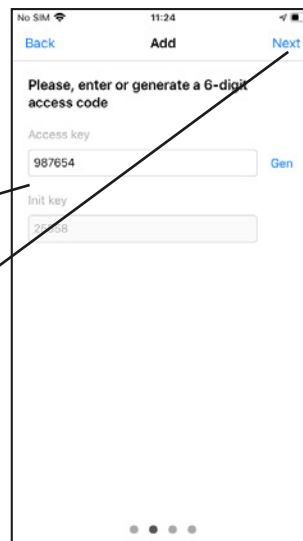

Fig. 4

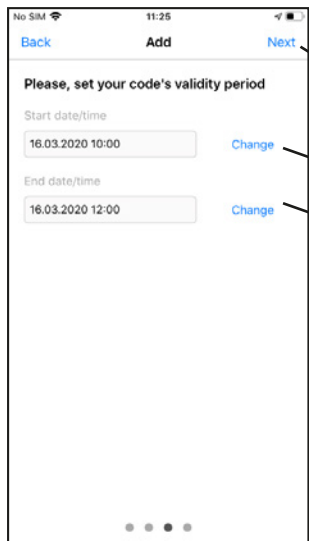

Fig. 5

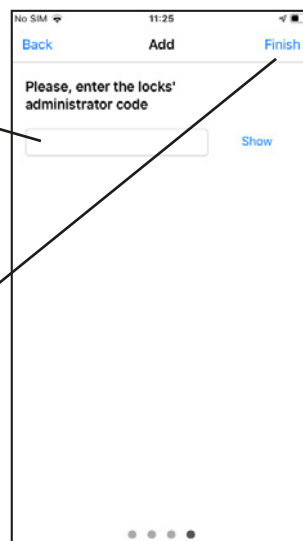

Fig. 6

The transmission is completed after a short period and the lock recognises the Init Key and the access code. Confirm with "OK". The Init Key must be entered once on the keypad belonging to the lock (enter 5 digits and press Enter) in order to activate the access code. Then the lock can be opened using the access code.

For increased security, we use the 2-factor authentication. The access code is sent per e-mail, the Init Key in an SMS. (Old) access codes can be deleted.



Fig. 1

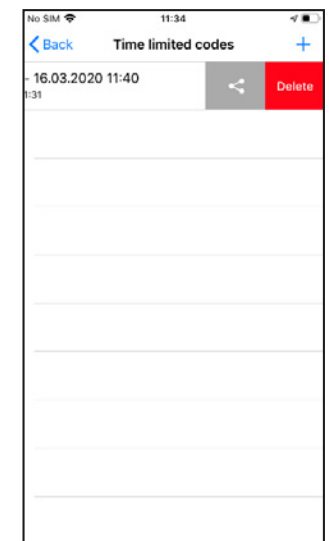

Fig. 2

Share access code and Init Key:

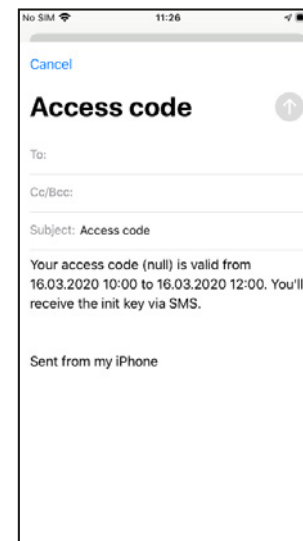

Fig. 1

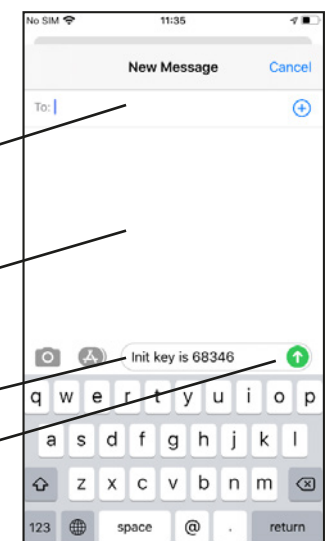

Fig. 2

Delete an access code:

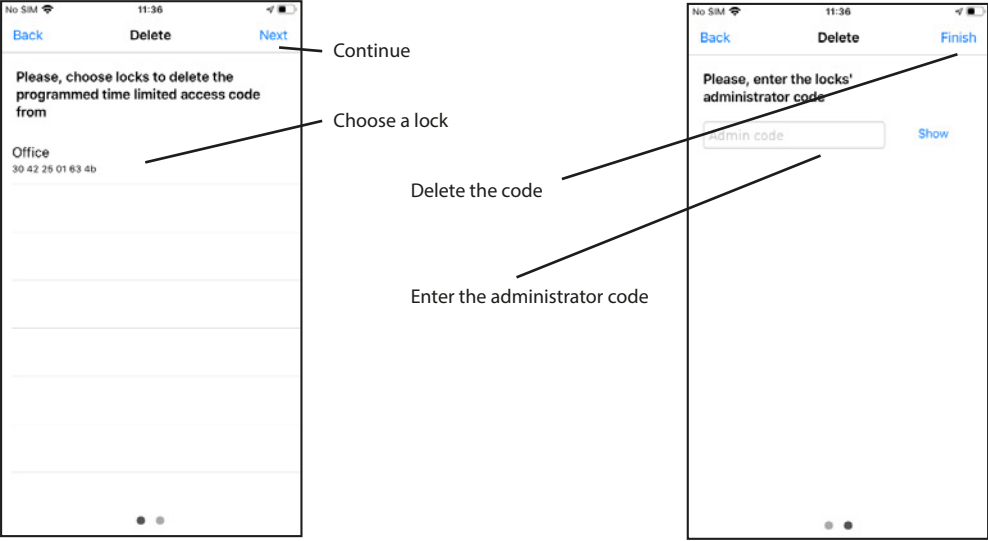

Fig. 1

Fig. 2

5.3 Video Bell

With a DOOR eGUARD Video Bell, you can see what your device sees using these functions. Communicate with the other party via two-way audio. It is also possible to take photos/videos and open an assigned lock.

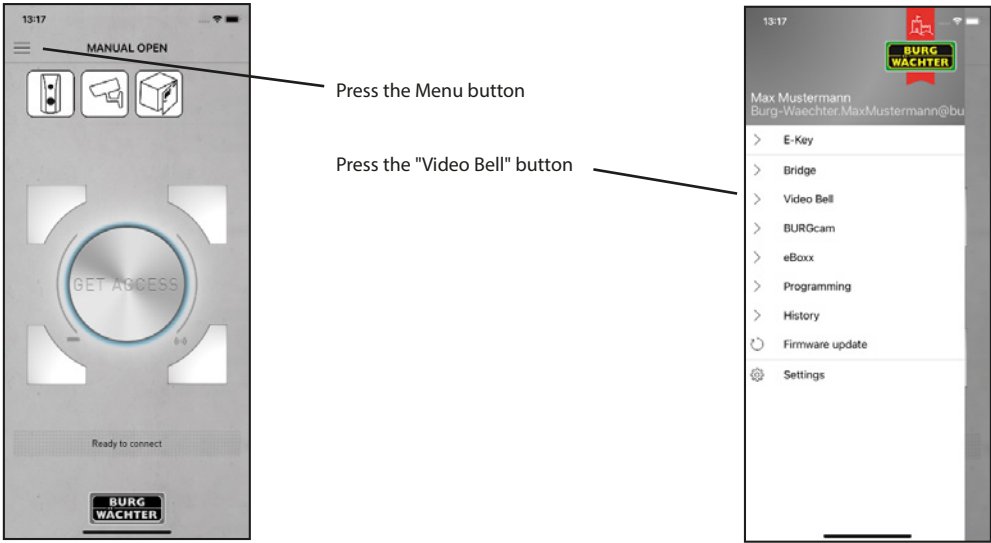

Fig. 1

Fig. 2

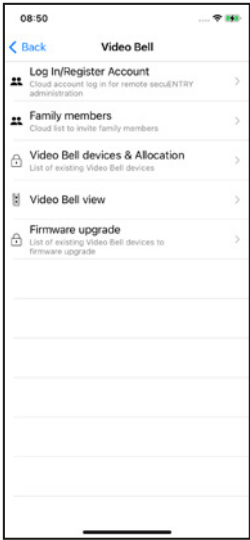

Fig. 3

5.3.1 Login / create an account

If you have made a decision for a Cloud Account during setup and have not logged out since then, you can skip this step. Otherwise you will have to login or create a new account.

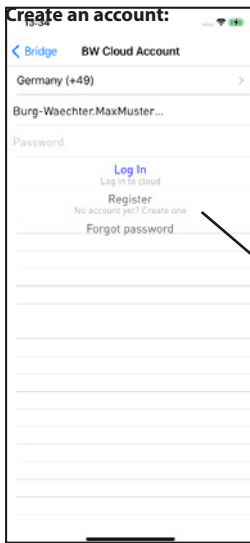

Fig. 4

Click on this button to access for registration.

Choose a password and enter it.

Press the button to receive a verification code per e-mail



Fig. 5



Fig. 6

Enter the 6 digit verification code that you have received per e-mail.

Press the button to complete the registration

You have successfully registered and logged in.



Fig. 7

Log in:

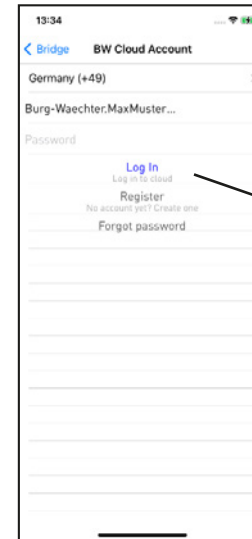

Fig. 1

Enter your password and press the button

You have successfully logged in.



Fig. 2

Log out:



Fig. 1

Press this button

Change password:

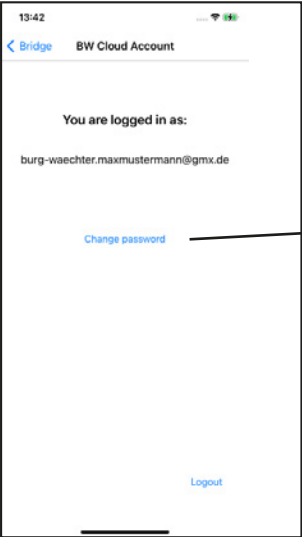

Fig. 1

Press this button

Enter the 6 digit verification code that you have received per e-mail and press the button.



Fig. 2



Fig. 3

Enter your new password. Press the command button

Press this button



Fig. 4

Recover password:

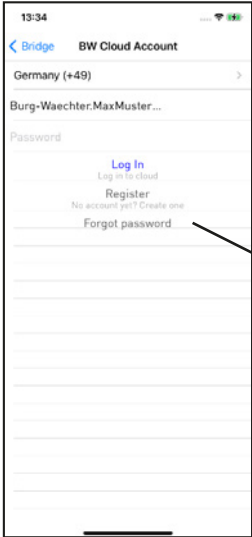

Fig. 1

Press this button

Enter your email address and press the button



Fig. 2



Fig. 3

Enter the 6 digit verification code that you have received per e-mail and press the button.

Enter your new password. Press the command button

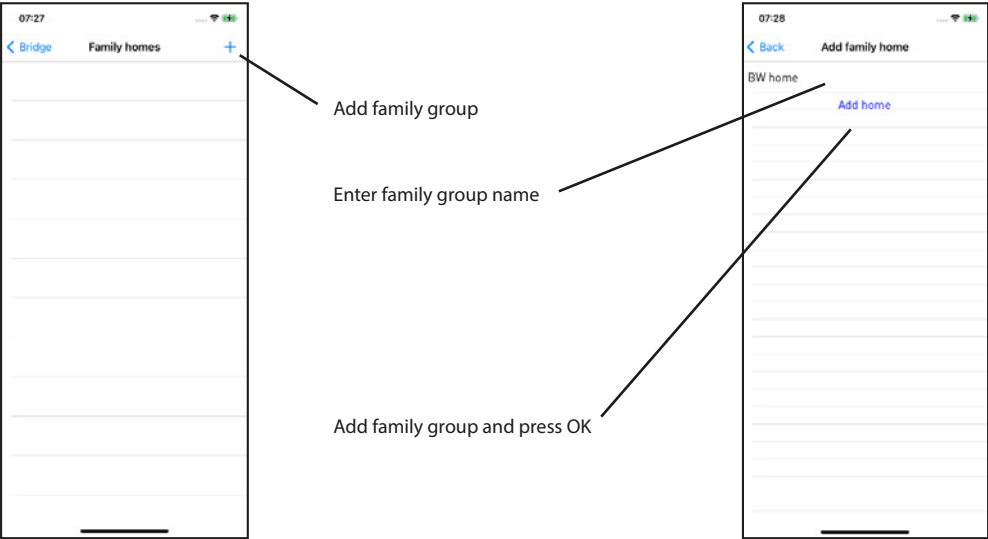

Fig. 4

5.3.2 Family

The Family functions make it easy for families to set up Bridges, BURGcams and Video Bells. The devices must be set up just once by the family administrator. The administrator must then add a family group and invite the rest of the family members to it. Once the invitations have been accepted, the devices are available to all family members.

Add family group:



Add family group

Enter family group name

Add family group and press OK

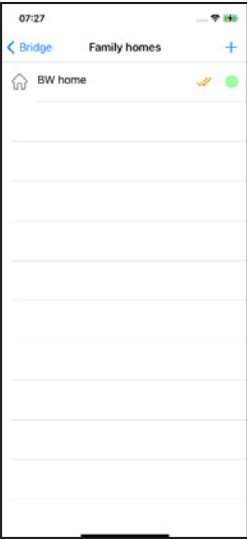

Fig. 3

Activate family group:

If several family groups are entered, one of them must be marked as the currently active group. The active group is displayed with the double tick. Access is available to the devices of the active family group.

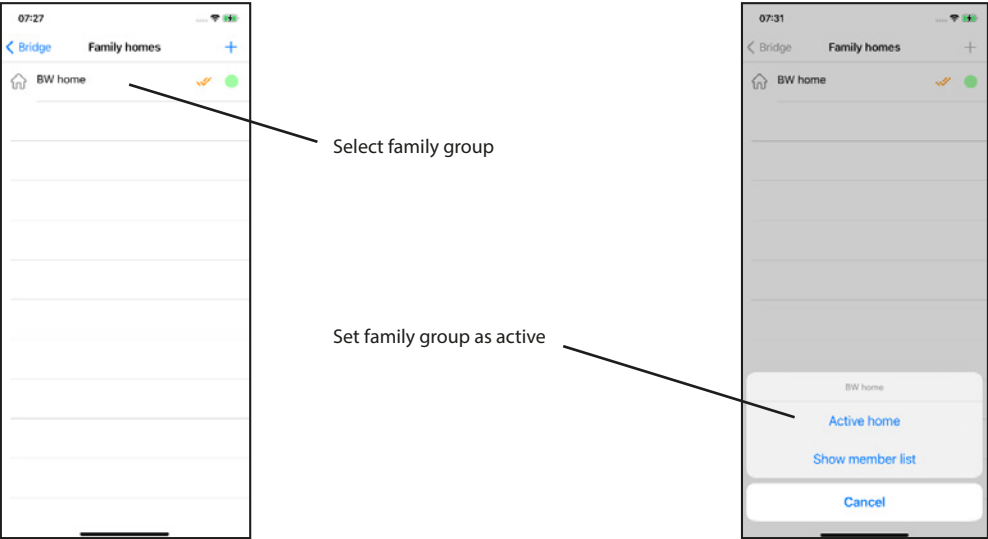

Fig. 1

Fig. 2

Select family group

Set family group as active

Delete family group:

Family groups cannot be deleted. Only the connection between cloud accounts and family groups can be removed.

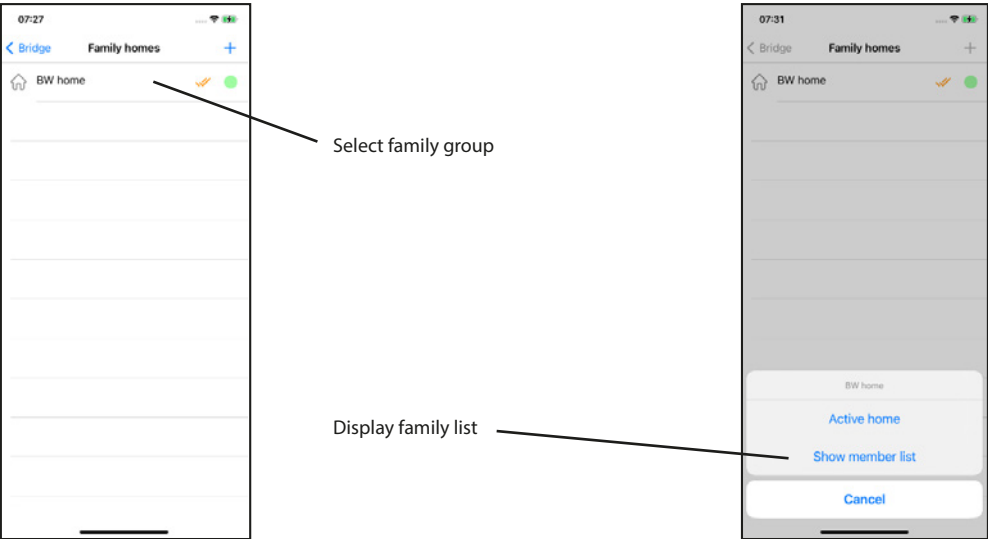

Fig. 1

Fig. 2

Select family group

Display family list



Fig. 3



Fig. 4

Add family members:

Family members can only be added by the family administrator.



Fig. 1



Fig. 2

Display family members:

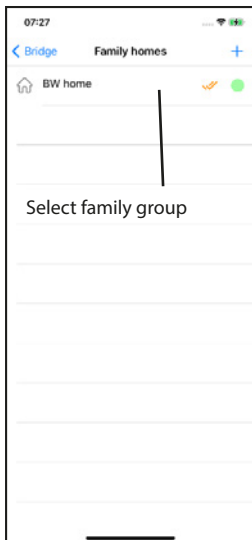

Fig. 1



Fig. 2



Fig. 3



Fig. 3



Fig. 4

An invitation that has been sent must first be accepted by the other family member before this member becomes part of the family group. Invitations that have not yet been accepted are marked with a yellow icon next to the name. These steps must be performed on the invited family member's smartphone.

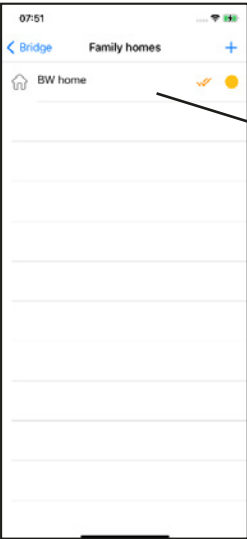

Fig. 1

Click on the invitation to the family group

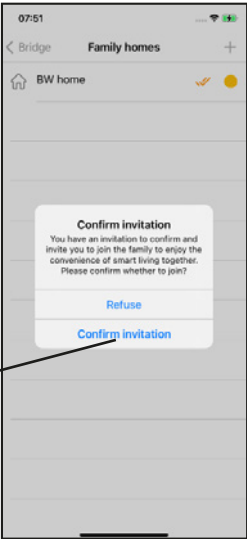

Fig. 2

Accept invitation

Remove family members:



Fig. 1

Select family group

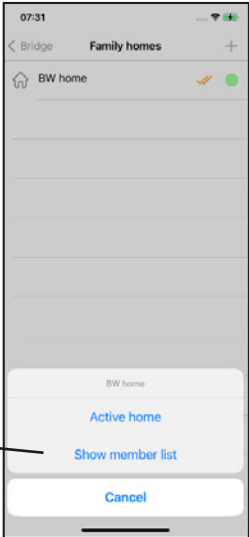

Fig. 2

Display family list



Fig. 3

Swipe the name of the family member to be removed to the left



Fig. 4

5.3.3 Video Bell units & assignments

Add Video Bell:

Switch on the Video Bell by moving the switch on the back panel to "ON".

The light circle around the bell button will flash.

Note: If the system is not operational, press and hold the reset button on the bottom of the unit for approximately 10 seconds.



Fig. 1

Add Video Bell

Enter a name for the Video Bell

Enter the password for your WLAN network

Press this button

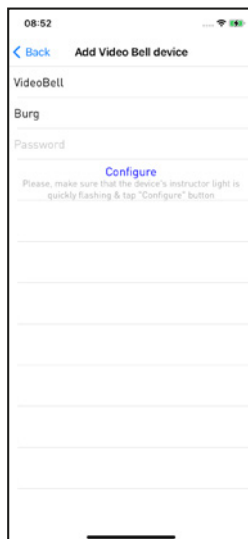

Fig. 2



Fig. 3

Hold the displayed QR code approx. 15-20 cm in front of the camera on the eGuard device until a beep sounds. Vary the distance if necessary. Then continue by pressing the button

Display unit information:



Fig. 1

Select Video Bell

Display unit information

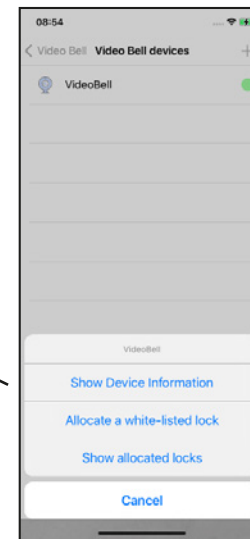

Fig. 2

The unit information is divided into the general unit information, the power management, the basic settings and the PIR settings.



Fig. 1

Unit information:



Fig. 1

Power Management settings:

This menu indicates whether the camera is connected to a power cable or whether it is battery-operated. In addition, it is possible to set the battery level at which an alarm signal is to be sent.



Fig. 1

- Battery level
- Type of power supply
- Tap to select the limit

Set limit and confirm

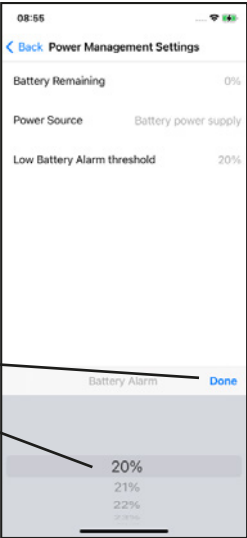

Fig. 2

Basic settings:

For example, if you mount the camera upside down due to lack of space, you can rotate the display here. The date and time can also be displayed.

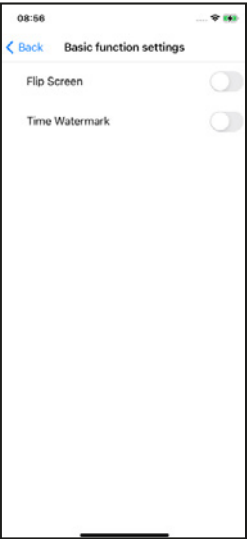

Fig. 1

- Turn the display upside down
- Show date/time

PIR:

The sensitivity of the PIR sensor can be adjusted.

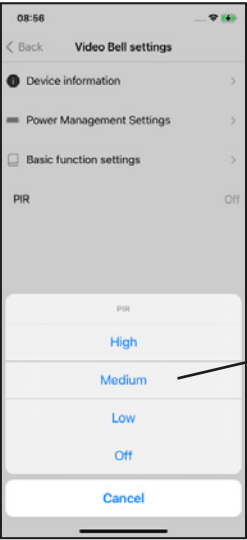
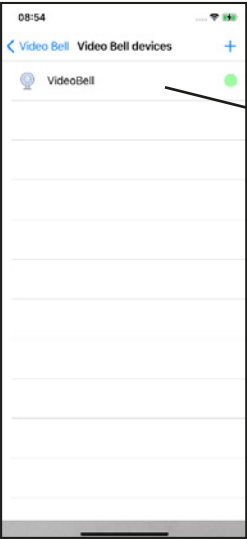

Fig. 1

- Tap
- Set sensitivity and confirm

Allocate a lock:



Select Video Bell

View locks in the WHITE list

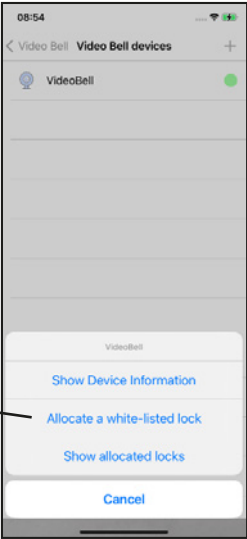
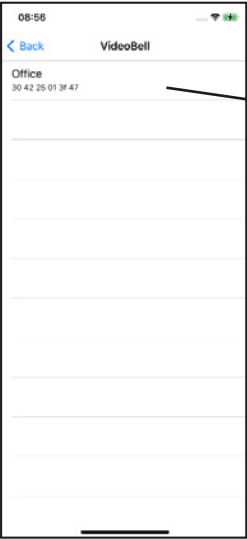

Fig. 2



Choose a lock

Fig. 3

Display assigned locks:

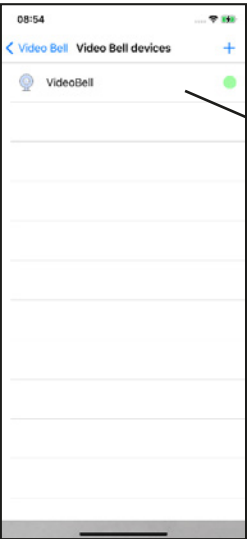

Select Video Bell

Show lock

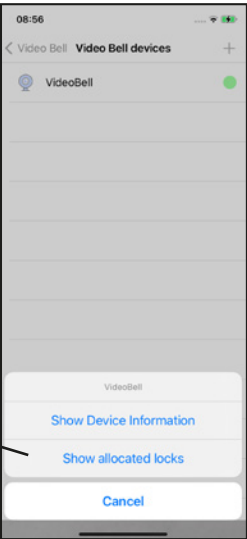

Fig. 2

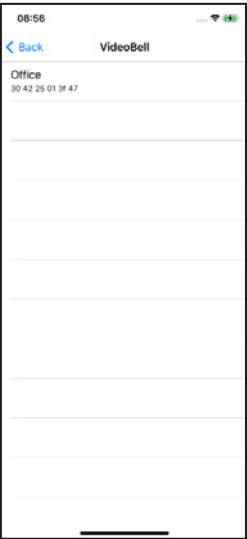

Fig. 3

Remove assigned locks:

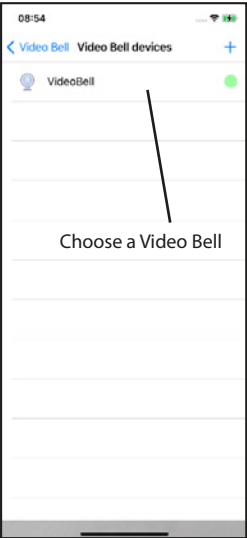

Fig. 1

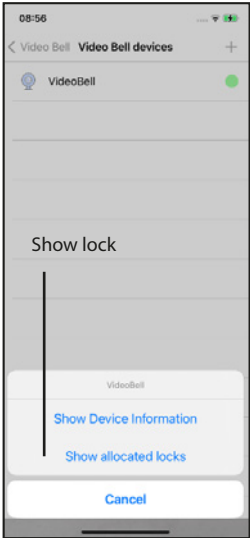

Fig. 2

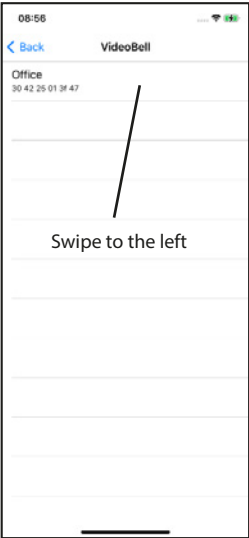

Fig. 3

Remove Video Bell:

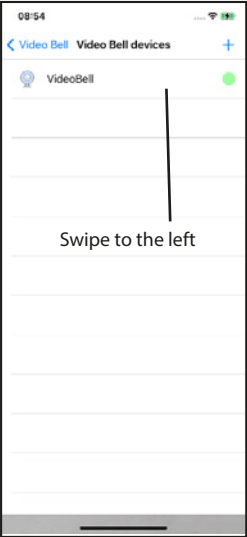

Fig. 1

5.3.4 Video Bell display

Locks that are contacted per Bridge may also contain access codes limited by time. In doing so however, it is important that these are also activated in the chronological order. One-time access keys are also possible in the future.

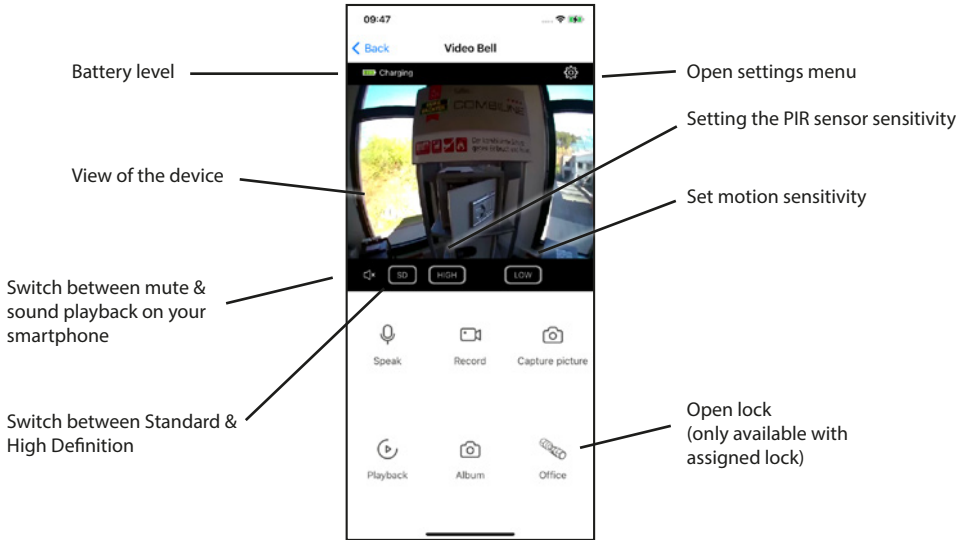

Fig. 1

- Speak:** Activates/deactivates the microphone enabling you to speak to the person at the door.
- Record:** Starts and stops the recording of video and sound images on the smartphone,
- Take photo:** Saves a photo to the smartphone
- Playback:** Retrieves recordings from the SD card inserted in the device
- Album:** Opens your photo/video app to view the recorded media

Important: Please observe the legal requirements of the General Data Protection Regulation (GDPR).

5.3.5 Firmware update

Future Video Bell unit firmware updates can be imported via this menu item.



Fig. 1



Fig. 2

5.3.6 Direct access button

The direct access button enables the user to open the view of a selected DOOR eGUARD Video Bell device from the start screen.



Fig. 1

Press

Select Video Bell and confirm with OK

If you wish to assign another unit to the direct access button, hold the button down longer. The menu shown above opens again.



Fig. 2

5.4 BURGCam

With a BURGCam you can see what your device sees using these functions. Communicate with the other party via two-way audio. It is also possible to take photos/videos and open an assigned lock.



Fig. 1

Press the Menu button

Press the "BURGCam" button

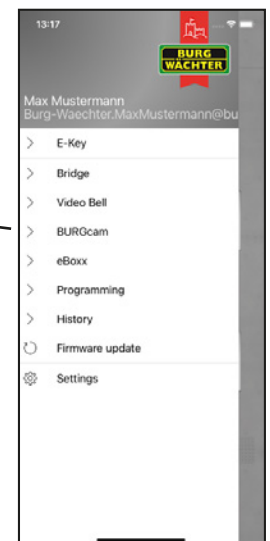

Fig. 2

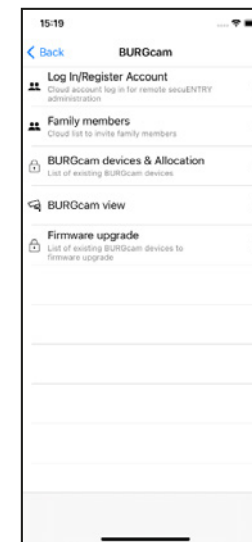

Fig. 3

5.4.1 Log in/Registration

If you have made a decision for a Cloud Account during setup and have not logged out since then, you can skip this step. Otherwise you will have to login or create a new account.

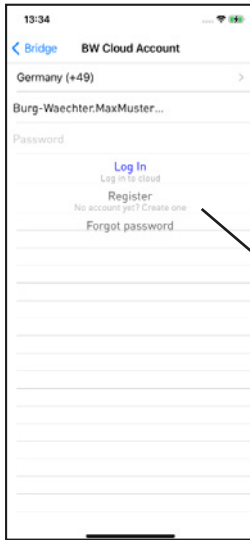

Fig. 4

Click on this button to access for registration.

Choose a password and enter it.

Press the button to receive a verification code per e-mail



Fig. 5

Enter the 6 digit verification code that you have received per e-mail.

Press the button to complete the registration

You have successfully registered and logged in.



Fig. 6



Fig. 7

Log in:

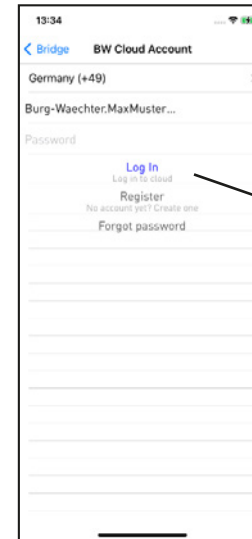

Fig. 1

Enter your password and press the button

You have successfully logged in.



Fig. 2

Log out:

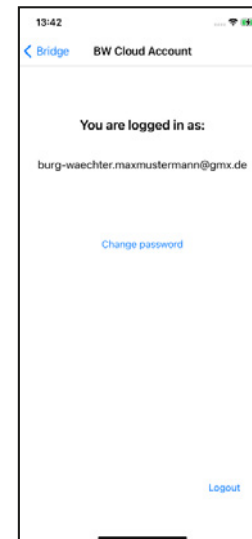

Fig. 1

Press this button

Change password:

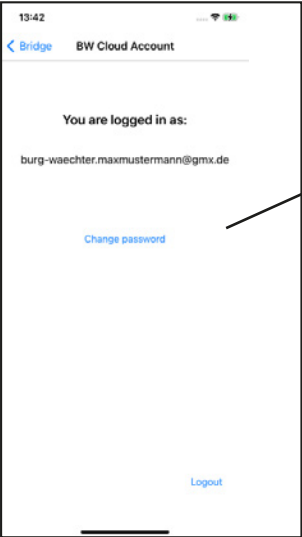

Fig. 1

Press this button

Enter the 6 digit verification code that you have received per e-mail and press the button.



Fig. 2

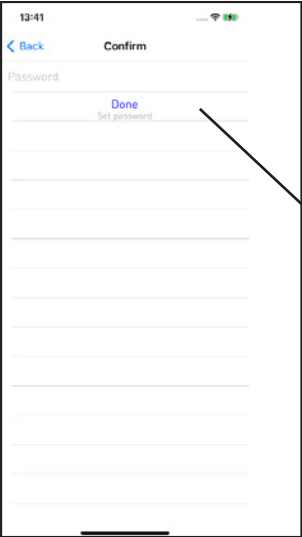

Fig. 3

Enter your new password. Press the command button

Press this button



Fig. 4

Recover password:

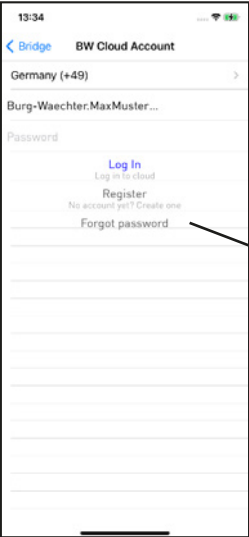

Fig. 1

Press this button

Enter your email address and press the button



Fig. 2

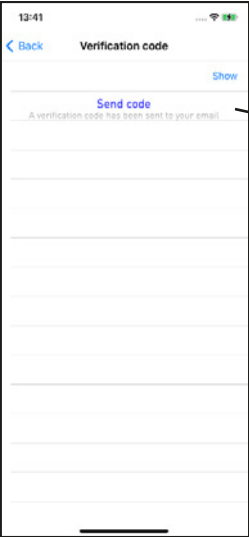

Fig. 3

Enter the 6 digit verification code that you have received per e-mail and press the button.

Enter your new password. Press the command button



Fig. 4

5.4.2 Family

The Family functions make it easy for families to set up Bridges, BURGcams and Video Bells. The devices must be set up just once by the family administrator. The administrator must then add a family group and invite the rest of the family members to it. Once the invitations have been accepted, the devices are available to all family members.

Add family group:

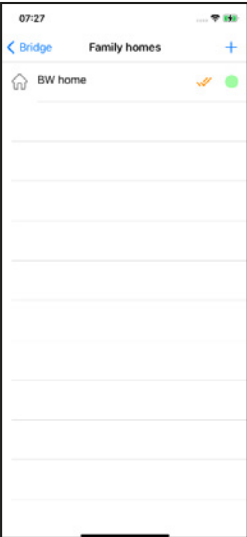
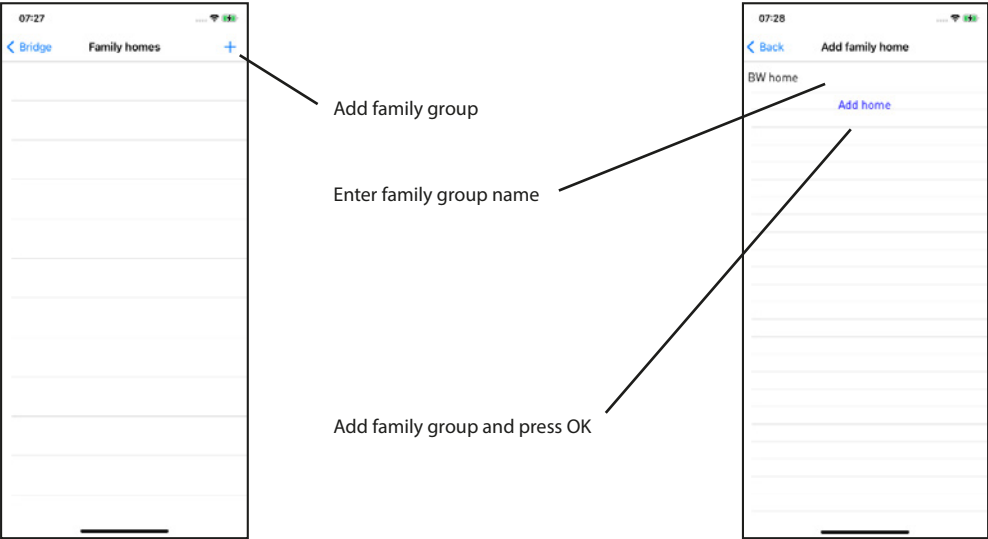
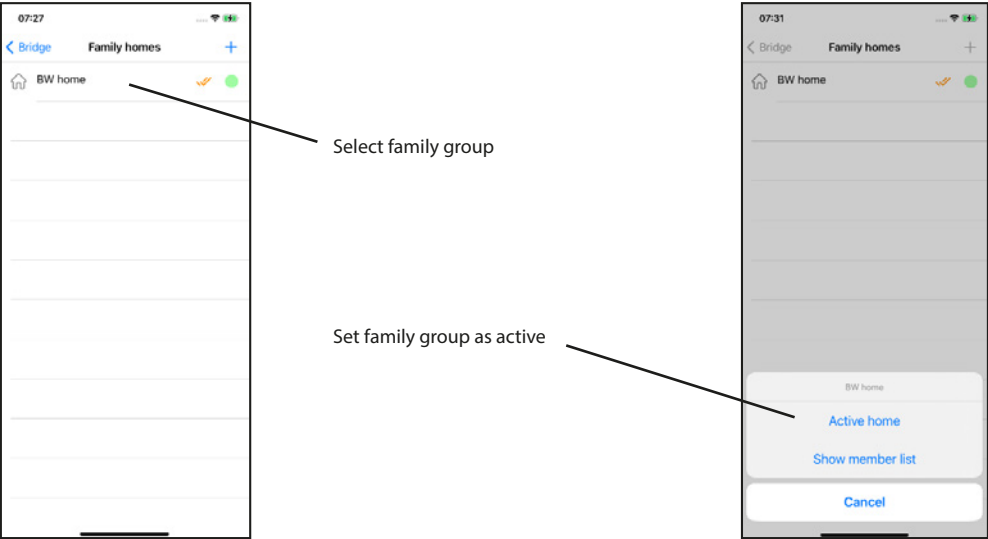

Fig. 3

Activate family group:

If several family groups are entered, one of them must be marked as the currently active group. The active group is displayed with the double tick. Access is available to the devices of the active family group.



Delete family group:

Family groups cannot be deleted. Only the connection between cloud accounts and family groups can be removed.

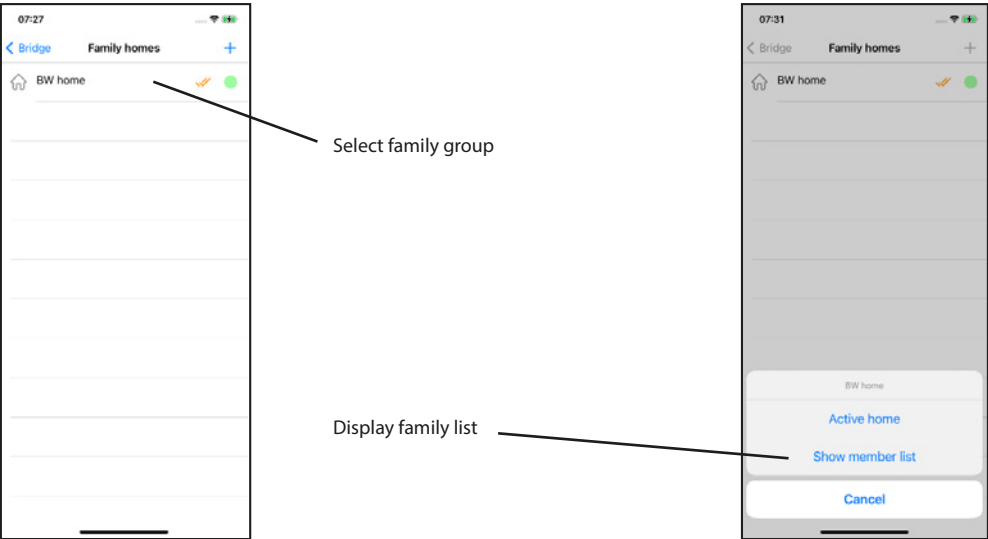



Fig. 3



Fig. 4

Add family members:

Family members can only be added by the family administrator.



Fig. 1



Fig. 2

Display family members:

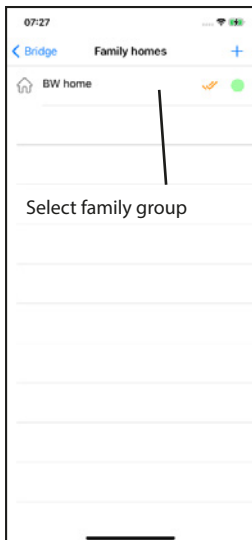

Fig. 1



Fig. 2



Fig. 3



Fig. 3

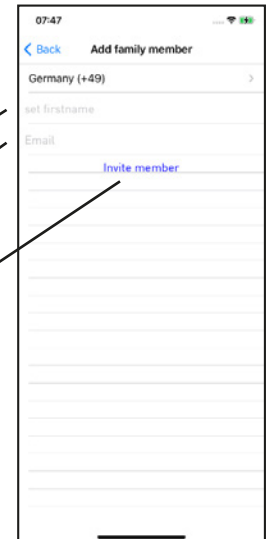

Fig. 4

An invitation that has been sent must first be accepted by the other family member before this member becomes part of the family group. Invitations that have not yet been accepted are marked with a yellow icon next to the name. These steps must be performed on the invited family member's smartphone.

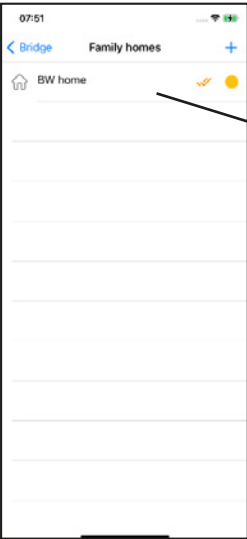

Fig. 1

Click on the invitation to the family group

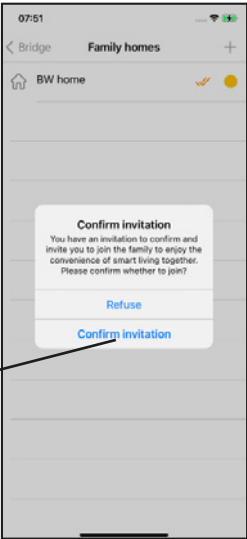

Fig. 2

Accept invitation

Remove family members:



Fig. 1

Select family group

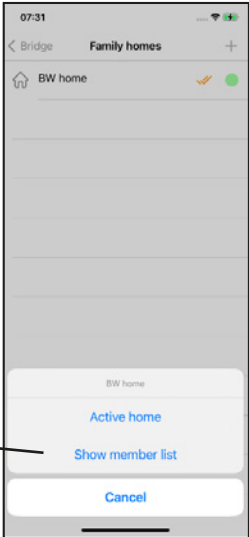

Fig. 2

Display family list



Fig. 3

Swipe the name of the family member to be removed to the left



Fig. 4

5.4.3 BURGcam units & assignments

Add BURGcam:

Switch on the BURGcam by connecting the power cable. The camera will emit an acoustic signal.



Fig. 1

Add BURGcam

Enter a name for the BURGcam

Enter the password for your WLAN network

Press this button

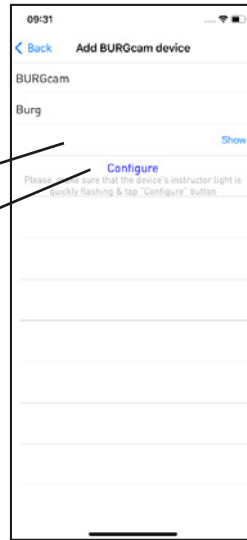

Fig. 2



Fig. 3

Hold the displayed QR code approx. 15-20 cm in front of the camera until a beep sounds. Vary the distance if necessary. Then continue by pressing the button



Fig. 4

Display unit information:



Fig. 1

Select BURGcam

Display unit information

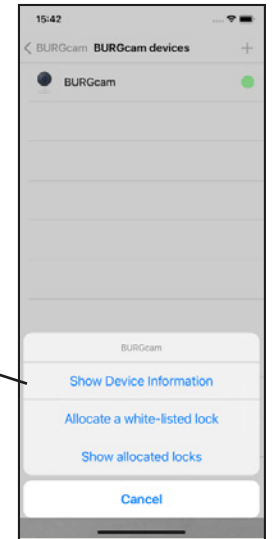

Fig. 2

The unit information is divided into the general unit information, the power management, the basic settings and the PIR settings.

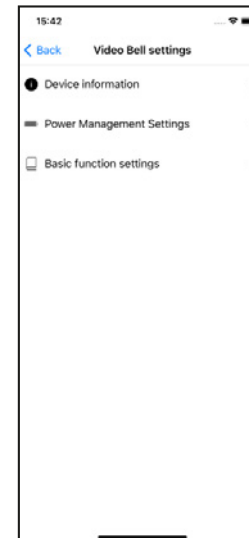

Fig. 1

Unit information:



Fig. 1

Power Management settings:

More information will be displayed in this menu in the future.
Currently, this menu is only designed for battery-operated cameras (Video Bell).

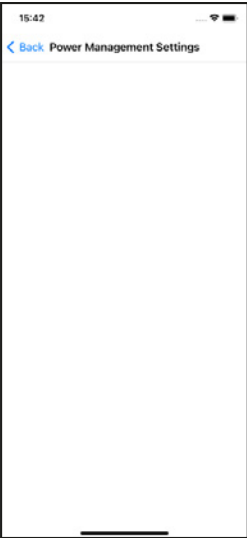
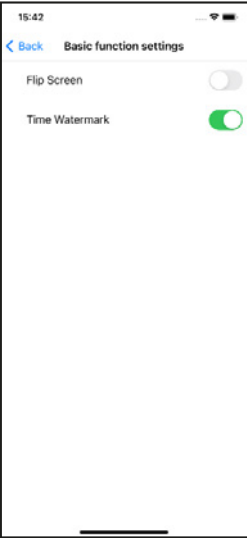

Fig. 1

Basic settings:

For example, if you mount the camera upside down due to lack of space, you can rotate the display here. The date and time can also be displayed.



- Turn the display upside down
- Show date/time

Fig. 1

Allocate a lock:

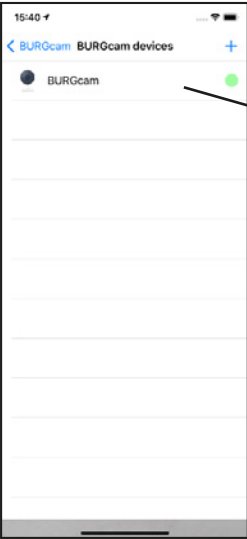

Select BURGcam

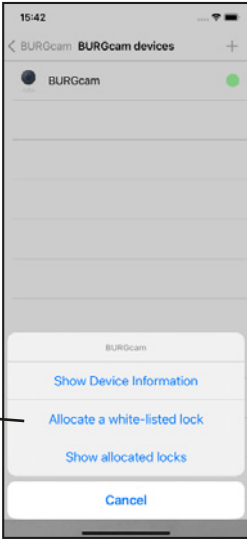

View locks in the WHITE list

Fig. 1

Fig. 2

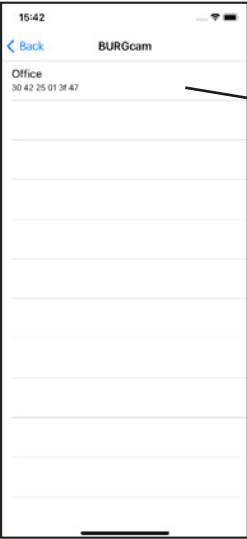

Choose a lock

Fig. 3

Display assigned locks:

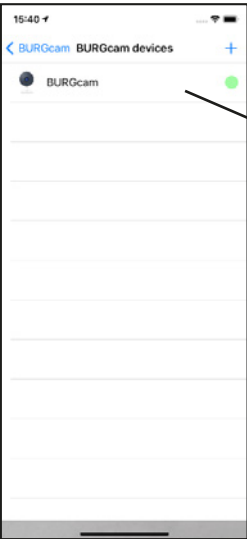

Select BURGcam



Show lock

Fig. 1

Fig. 2

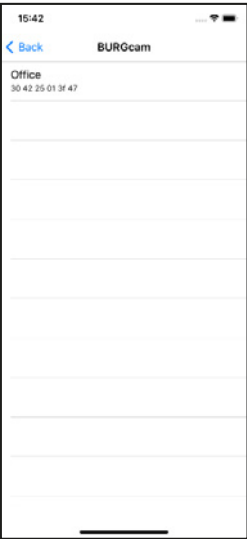

Fig. 3

Remove assigned locks:

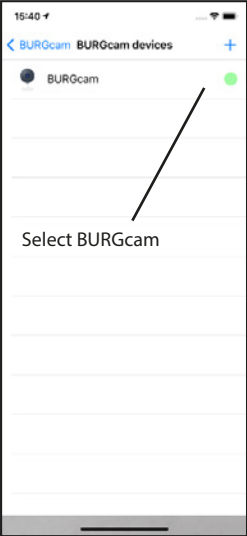

Fig. 1



Fig. 2



Fig. 3

Remove Video Bell:

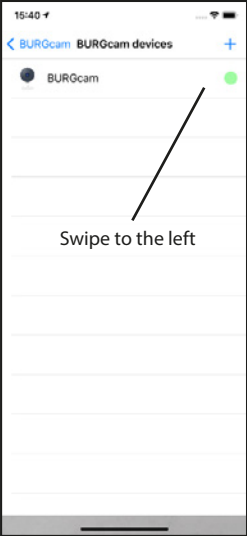

Fig. 1

5.4.4 BURGcam display

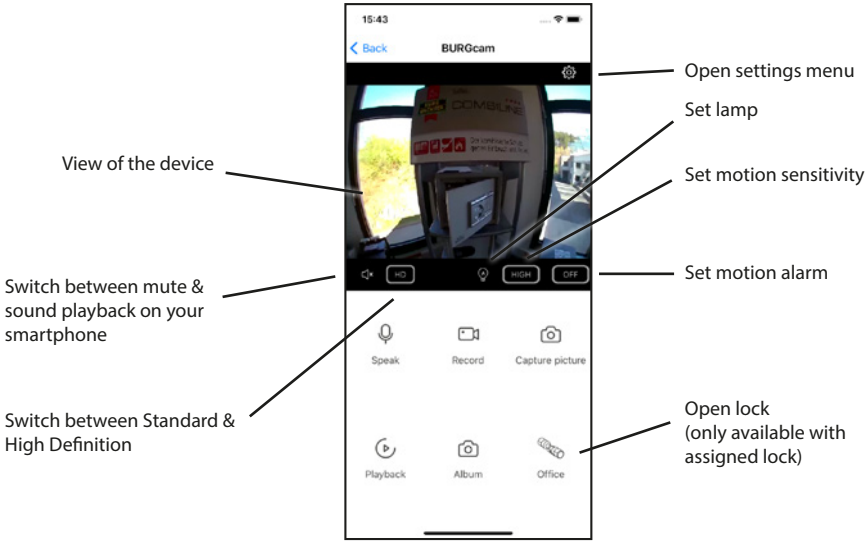

Fig. 1

- Speak:** Activates/deactivates the microphone enabling you to speak to the person at the door.
- Record:** Starts and stops the recording of video and sound images on the smartphone,
- Take photo:** Saves a photo to the smartphone
- Playback:** Retrieves recordings from the SD card inserted in the device
- Album:** Opens your photo/video app to view the recorded media

Important: Please observe the legal requirements of the General Data Protection Regulation (GDPR).

5.4.5 Firmware update

Future Video Bell unit firmware updates can be imported via this menu item.



Fig. 1



Fig. 2

5.4.6 Direct access button

The direct access button enables the user to open the view of a selected BURGcam device from the start screen.



Fig. 1



Fig. 2

5.5 eBoxx

An eBoxx EASY+ allows you to receive parcels securely when you are away. Generated codes that you communicate to the deliverers enable them to deliver your parcels.



Fig. 1

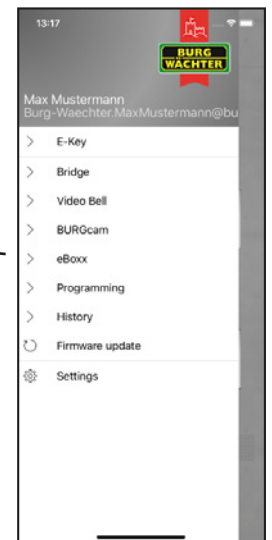

Fig. 2



Fig. 3

5.5.1 eBoxx settings

In order to be able to set up your eBoxx for users, you must first register them in the KeyApp.

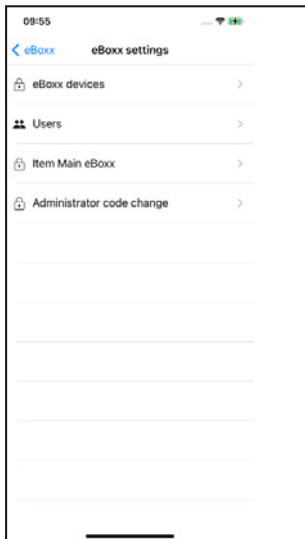

Fig. 1

5.5.1.1 eBoxx units

In order to be able to set up your eBoxx for users, you must first register them in the KeyApp.

Register eBoxx:



Fig. 1

Add a new lock

The the camera opens. Scan the QR code of your device



Fig. 1

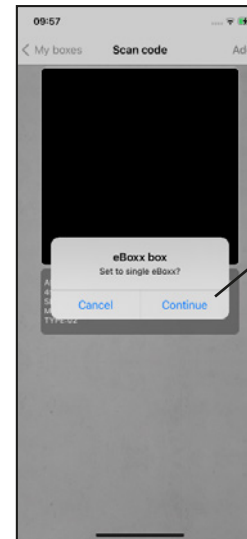

Fig. 3

Then press the "Continue" button

Enter the name for the device and corresponding administrator or user code. Press the "Start" button.

It takes just a short time for the eBoxx to be registered. Press the "OK" button.

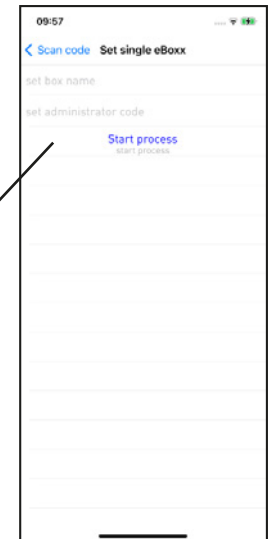

Fig. 4

Delete eBoxx:

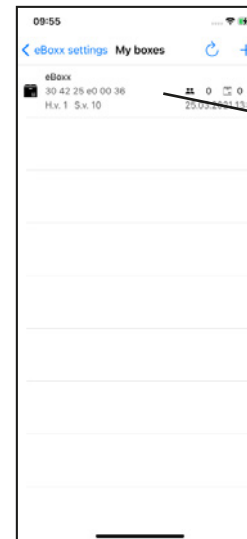

Fig. 1

Delete eBoxx to the left

Press the icon that appears on the right

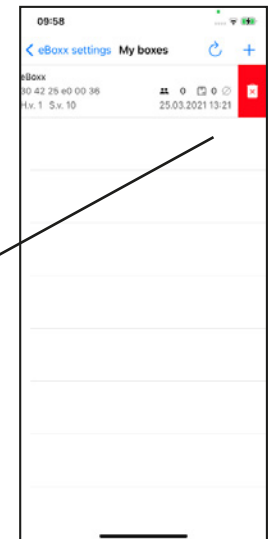

Fig. 2

5.5.1.2 User

You can create, delete or reset user codes in the user menu to assign a new code.

Create user code:



Add a new user

Select the eBoxx for which you want to create the new user

Fig. 1



Fig. 2

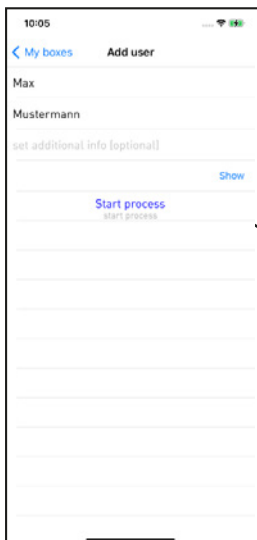

Enter the details of the user and the administrator code and press the "Start" button.

After a short time, the user is created and the user code is displayed. Press the "OK" button.

Fig. 3

Reset user code:



Swipe the user to the right and press the icon that appears on the left.

Enter the administrator code and press the "Reset code" button.

After a short time, the user code is reset and displayed. Then press the "OK" button

Fig. 1

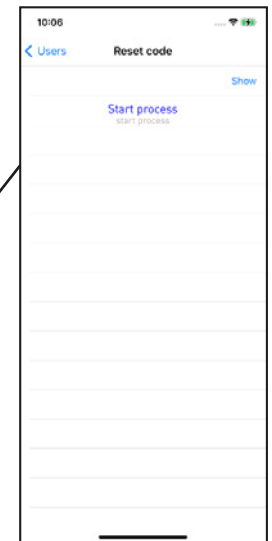

Fig. 2

Delete user code:



Swipe the user to the left and press the icon that appears on the right.

Enter the administrator code and press the "Delete" button.

Fig. 1

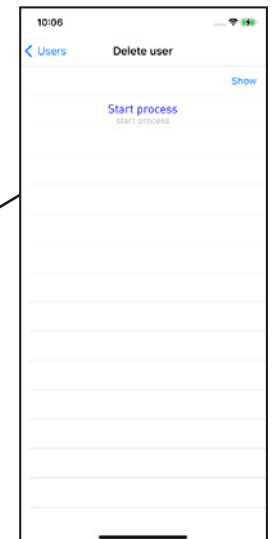

Fig. 2

5.5.1.3 My eBoxx

This menu item is only relevant for you if you have several parcel boxes.

If you have an eBoxx system (more than one eBoxx), perform commissioning and setting up of all of the eBoxxes as described above. Persons authorised to use the eBoxx system must receive the user codes generated for each eBoxx. With the assigned user codes these designated persons can set up the eBoxxes assigned to them by the administrator for their own use. You (the administrator) must select via the KeyApp the eBoxxes intended for your own use. The eBoxx is set up according to chapter "Account settings" for the parcel box marked as a dedicated eBoxx in this menu.

Create user code:



Fig. 1

Press the icon located at the top right

Select the eBoxx which you wish to configure

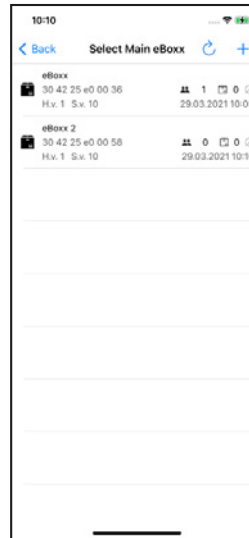

Fig. 2

5.5.2 Account settings

This menu includes all the settings that a user can perform without the administrator.

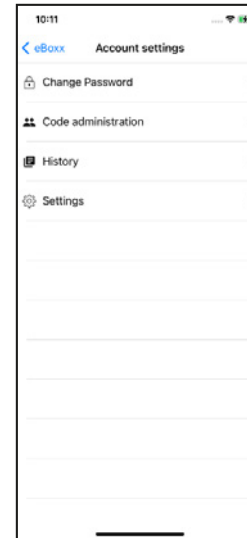

Fig. 1

5.5.2.1 Code change

This menu includes all the settings that a user can perform without the administrator.

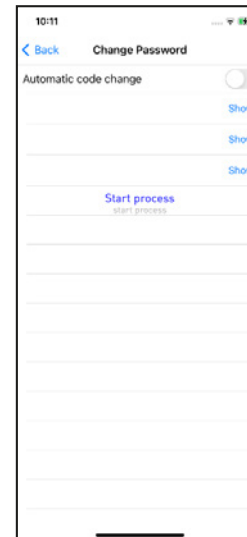

Fig. 1

Set whether you would like to choose a code yourself or whether a random code is to be generated.

Enter the old user code. If you want to choose a code yourself, enter the new code and repeat. Confirm your selection with the "star" button

After a short time, the user code is changed and displayed. Press the "OK" button.

5.5.2.2 Code management

As a user, generate deliverer and one-time codes to receive parcels. Generated one-time codes can only be used once. Alternatively, you can use a one-time code to transfer a parcel to other persons.



Fig. 1

Deliverer codes:

Deliverers can deliver your parcels. You can give the delivery codes you generate to the parcel delivery companies via delivery authorisation.



Fig. 1

Add a new deliverer.

Fill in the fields as desired and enter the user code. Press the "START PROCESS" button.

After a short time, the deliverer code is created and displayed. Press the "OK" button.

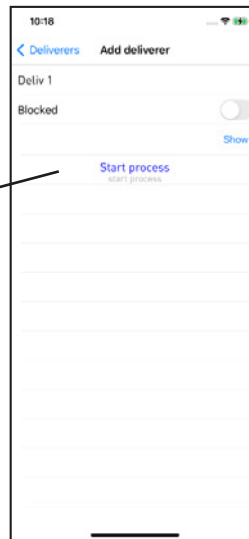

Fig. 2

Change deliverer code:



Fig. 1

Swipe the deliverer to the right and press the icon that appears on the left.

Fill in the fields as desired and enter the user code. Press the "Start" button.

After a short time, the deliverer code is changed and a new code is displayed. Press the "OK" button.

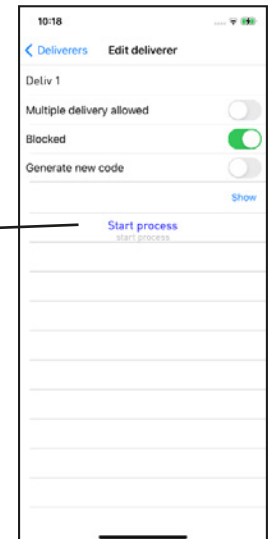

Fig. 2

Delete deliverer code:



Fig. 1

Swipe the deliverer to the left and press the icon that appears on the right.

Enter the user code and press the "Start" button.

It takes just a short time for the deliverer code to be deleted. Press the "OK" button.

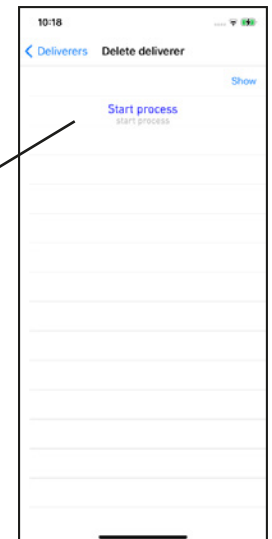
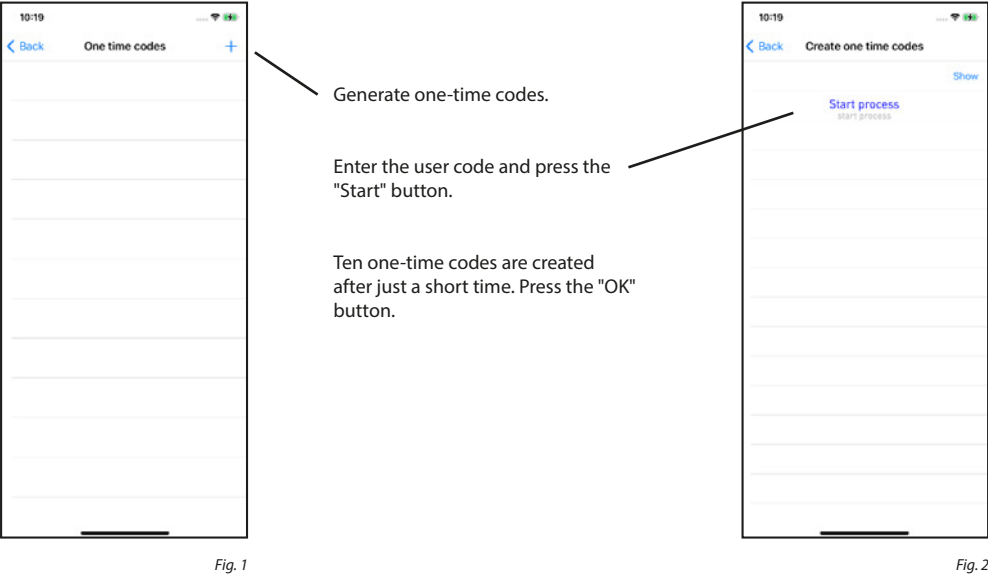

Fig. 2

Create one-time code

One-time codes lose their validity after use. They are ideal for transferring or receiving parcels only once.



Display one-time code

One-time codes lose their validity after use. They are ideal for transferring or receiving parcels only once.

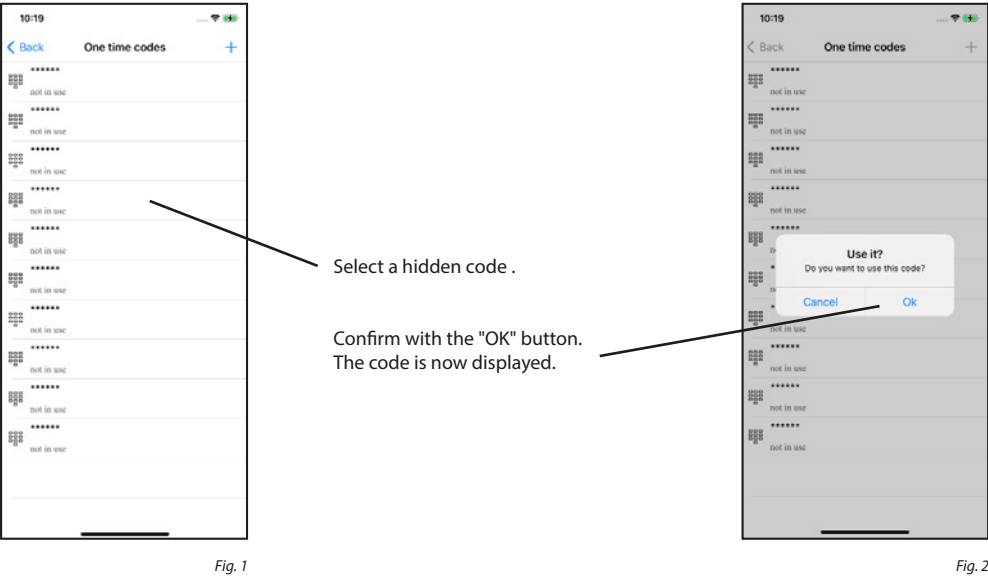

5.5.2.3 History

You can readout and display the history of the eBoxx. It is also possible to display the history of the app.

Readout history:

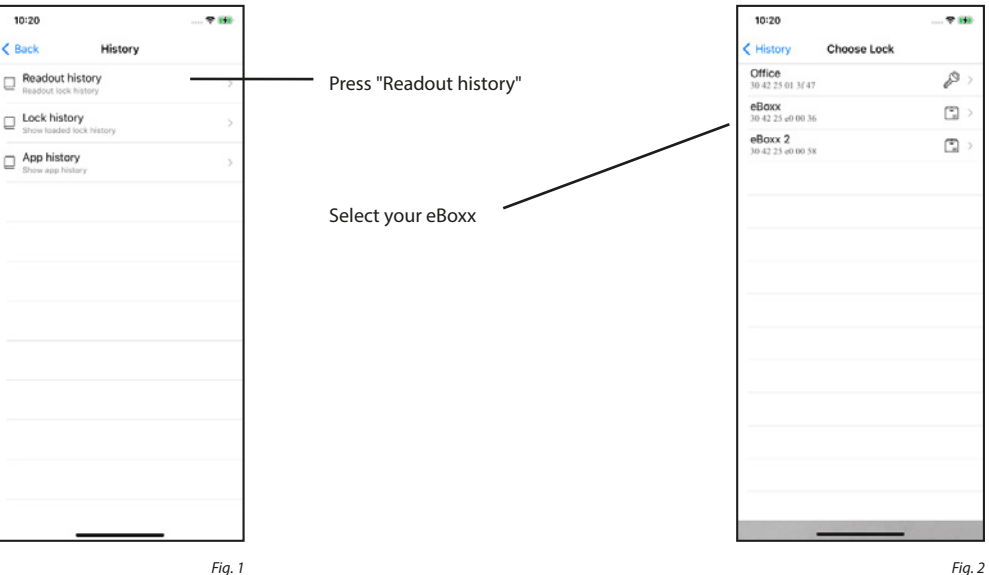

Display history:

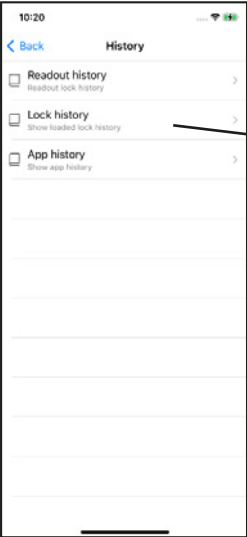

Fig. 1

Press "Lock history"

Select your eBoxx



Fig. 2

Delete eBoxx history file:

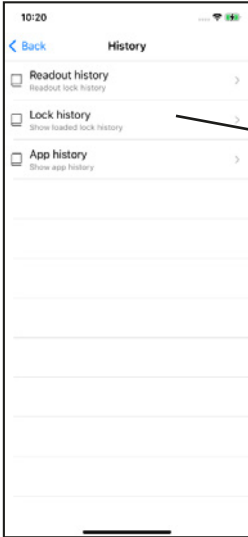

Fig. 1

Press "Lock history"

Select your eBoxx

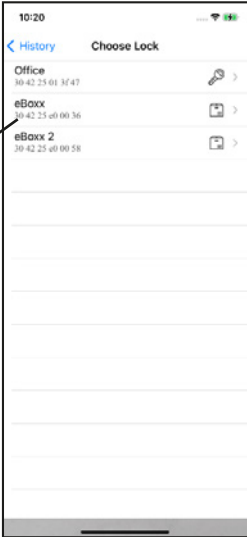

Fig. 2

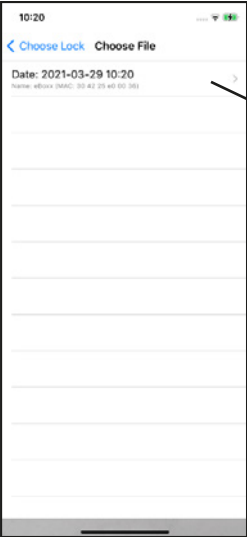

Fig. 3

Select the history file which you wish to display

Take the info from the history



Fig. 4



Fig. 3

Swipe the history file which you wish to delete to the left

Display KeyApp history:

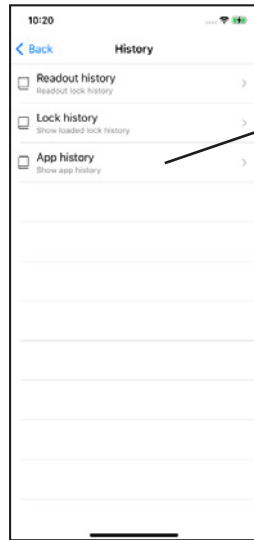

Fig. 1

Press "KeyApp history"

Select a history file



Fig. 2

Delete KeyApp history file:

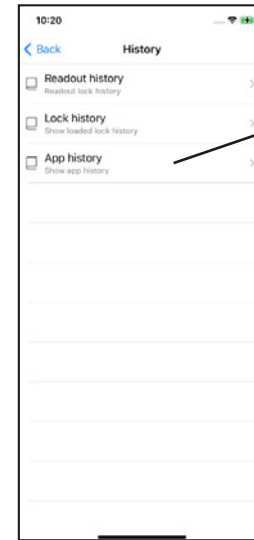

Fig. 1

Press "KeyApp history"

Swipe the history file which you wish to delete to the left

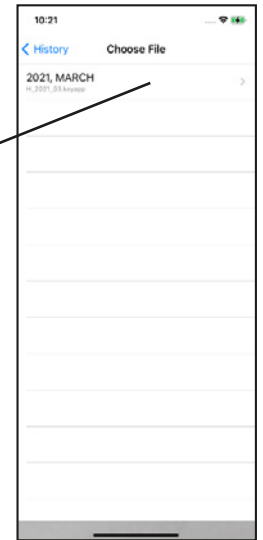

Fig. 2



Fig. 3

Lock

Result

Procedure

Date & time

5.5.2.3 Settings

This menu contains eBoxx settings that the user can perform.

Set date and time:



Fig. 1

Press "Set date and time"

Tap the input field



Fig. 2

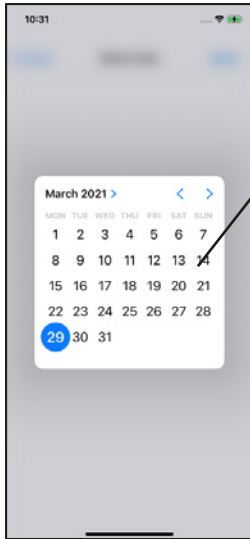

Fig. 3

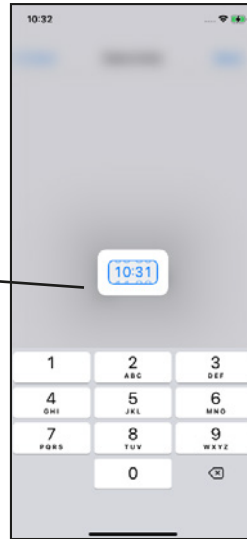

Fig. 4

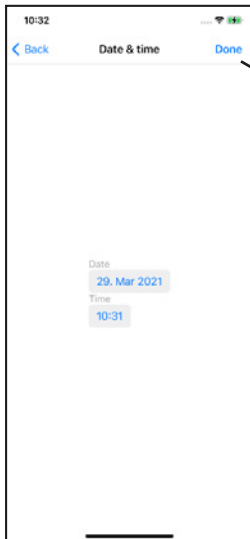

Fig. 5



Fig. 6

5.5.3 Direct access button

The direct access button enables you to perform a status query of your eBoxx unit from the start screen.

5.5.3.1 Assign direct access button



Fig. 1



Fig. 2

If you wish to assign another unit to the direct access button, hold the button down longer. The menu shown above opens again.

5.5.3.2 Status query



Fig. 1

A status query is performed when the Direct access button is pressed. To open the eBoxx, you must wait until the query has been executed. When the message "Open eBoxx EASY+" appears, you can open the eBoxx by pressing a button after approx. 2 seconds.

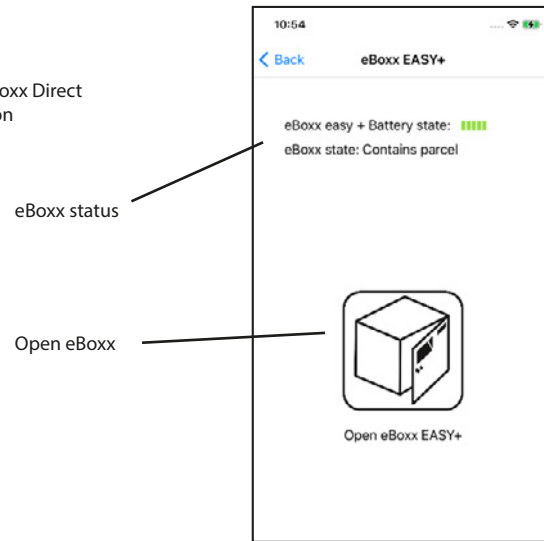

Fig. 2

5.6 Config file PC software

Config Files can be created using the PC software. These can be used to program locks and read out the history. For this purpose, the "zip" file must be loaded to your mobile phone and opened with the secuENTRY KeyApp. There are various Apps that make it possible to access your files in order to, for example, open these with the KeyApp.

5.6.1 Import config files

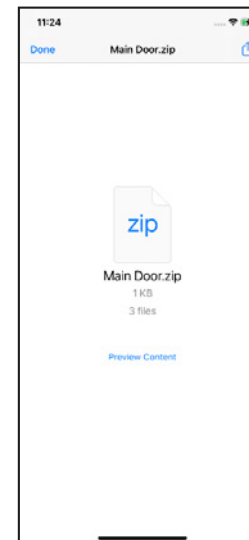

Fig. 1

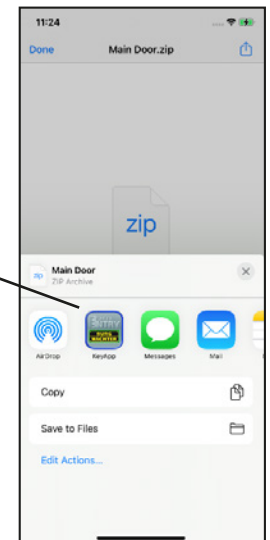

Fig. 2



Fig. 3

For the next functions, you have to open the "Programming config file" menu.



Fig. 1

Press the Menu button

Press the button
"Programming config file"

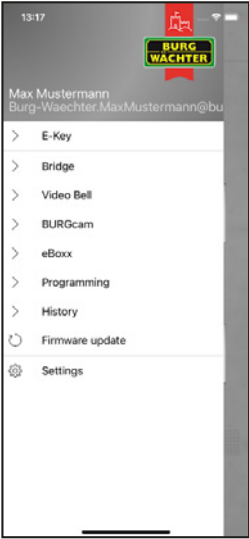

Fig. 2

5.6.2 Readout history

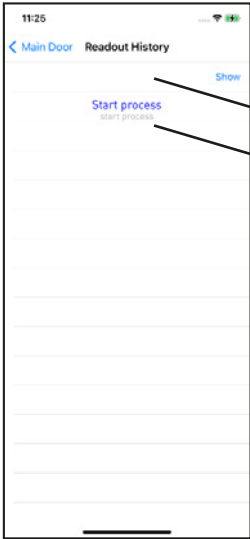

Fig. 1

Enter the
administrator code

Readout the history

The history of the lock is read out after a short period. Confirm with "OK". A description as to how you can view the history can be found in the "Display history" chapter.

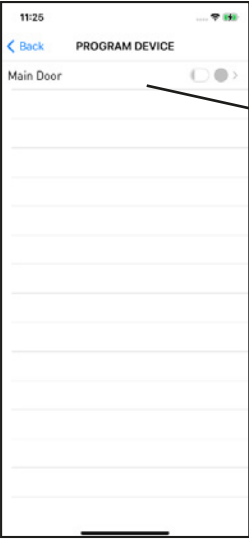

Fig. 3

Choose lock / config file



Fig. 4

Choose
history file

5.6.3 View history

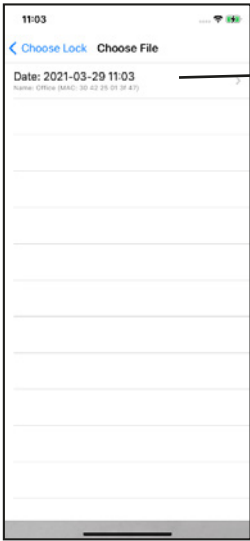

Fig. 1

Executed by

Date & time

Procedure

Battery level



Fig. 2

5.6.4 Remove history

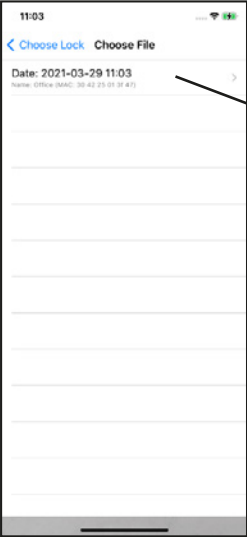

Swipe to the left

Fig. 1

5.6.5 Program lock

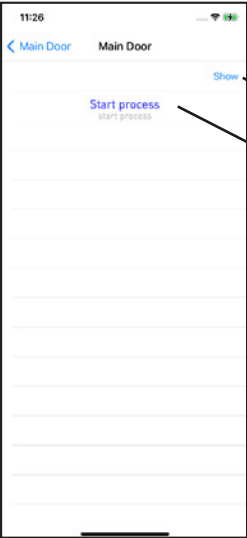

Enter the
administrator code

Program the lock

Fig. 1

5.6.6 Remove config files

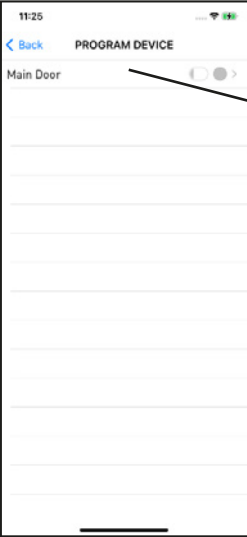

Swipe to the left

Fig. 1

5.7 History

The history provides information of the past about the lock and app.



Fig. 1

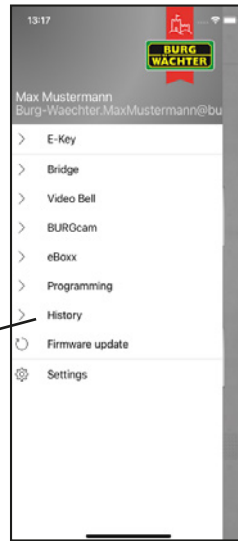

Fig. 2

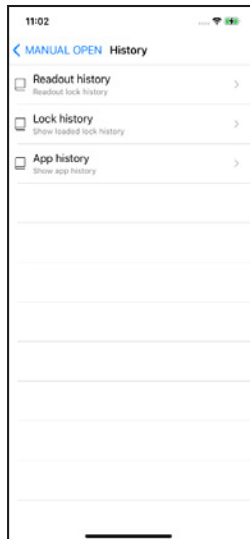

Fig. 3

5.7.1 Readout history

Read out the history of a lock:

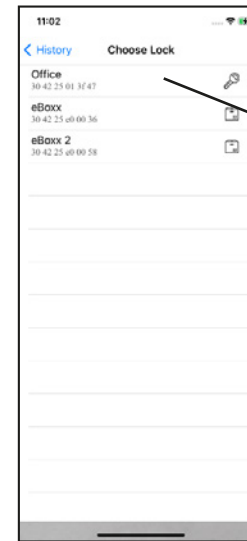

Fig. 1

Choose a lock

Enter the administrator code of the lock and press the button

Now the history is read out, confirm with "OK". You can then view the history as described under "Lock history".

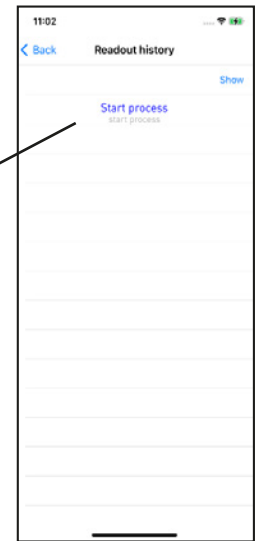
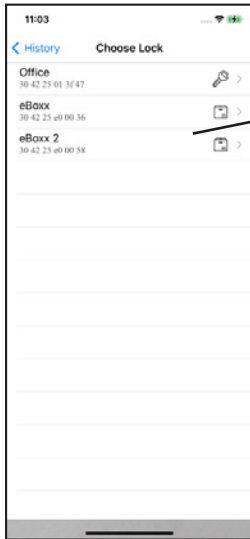

Fig. 2

5.7.2 Readout history Lock history

Display the history of a lock:



Choose a lock

Select the history data that you want to view

Fig. 1



Fig. 2

Remove a lock history:

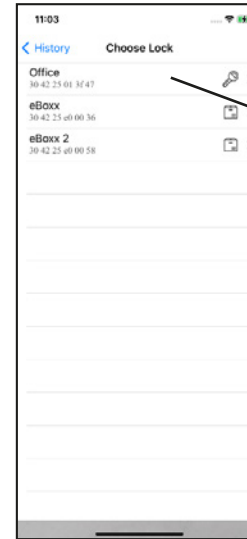

Choose a lock

Swipe to the left

Fig. 1

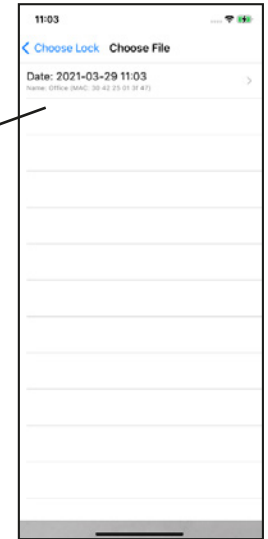

Fig. 2

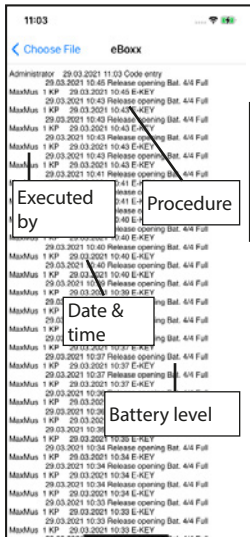

Fig. 3

5.7.3 KeyApp history

Display KeyApp history:

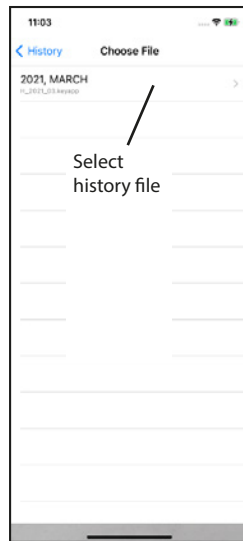

Fig. 1



Fig. 2

Remove KeyApp history:

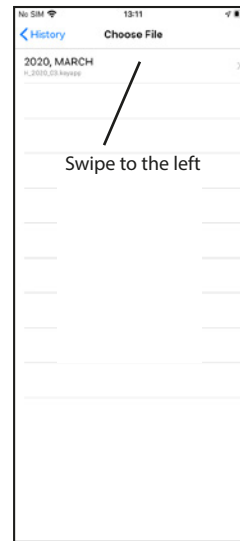

Fig. 1

5.8 Firmware update

With firmware updates, you can keep our products up-to-date. Executing a firmware update takes a few minutes. The batter level must therefore be considered in advance; change the batteries if necessary.



Fig. 1

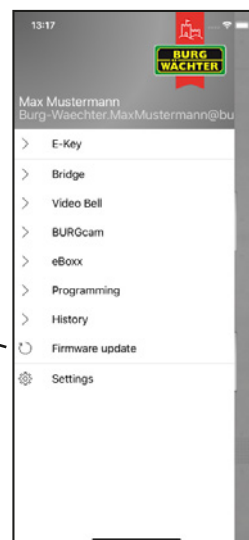

Fig. 2

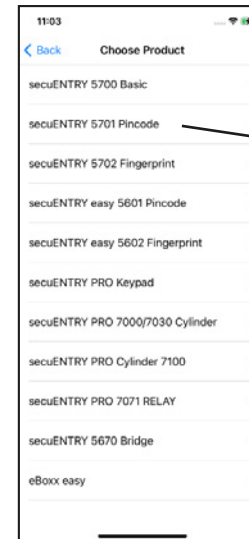

Fig. 3

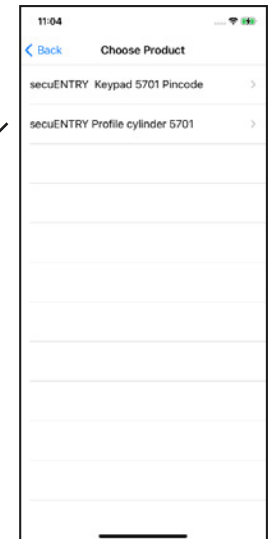

Fig. 4



Fig. 5

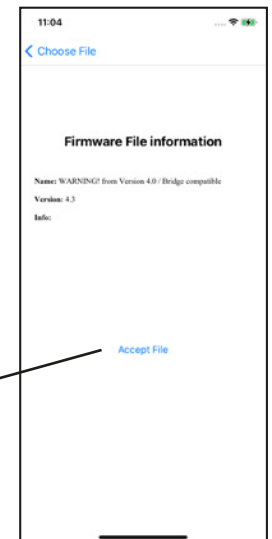

Fig. 6



Fig. 7

The the camera opens. Scan the QR code of your device

Then press the "OK" button

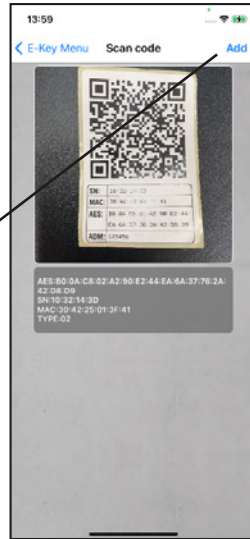

Fig. 8

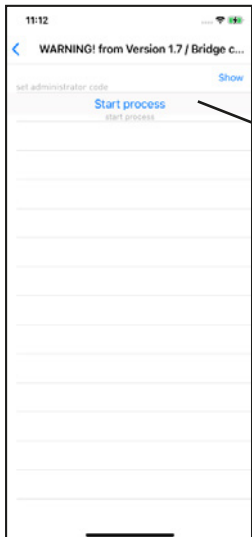

Fig. 9

Enter the administrator code of the device and press the "Start" button

The firmware update is installed after a few minutes. Then press the "OK" button

5.9 Settings

In the settings, a password can be selected to protect the app, and an administrator code can be set for all devices. Moreover, you can decide is anonymised data should be sent to BURG-WÄCHTER, which are used to improve the app. You can also view information such as, the version of the app.



Fig. 1

Press the Menu button

Press the "Settings" button

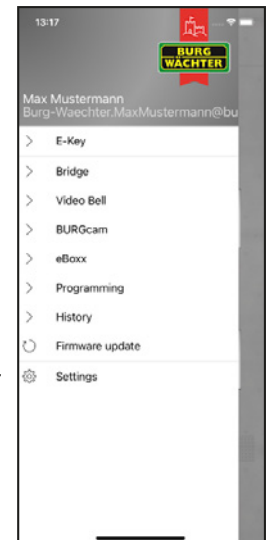

Fig. 2

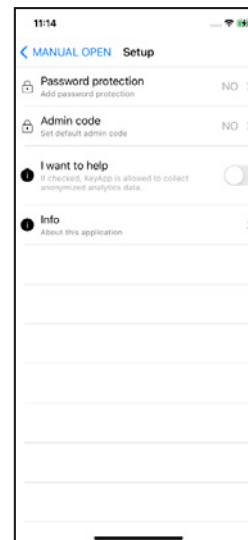
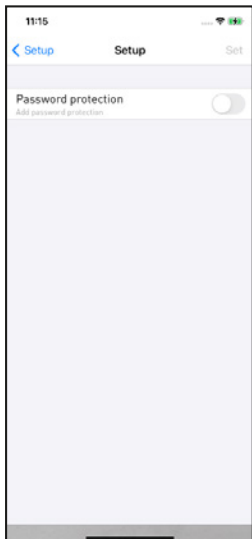

Fig. 3

5.9.1 Password

Protect the app with an additional 4 digit password.



Switch on the function

4 digit password

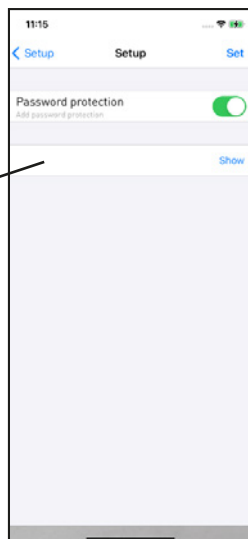

Fig. 1

Fig. 2

5.9.2 Administrator code

With this function, the same administrator code can be pre-set for all devices. As a result, the administrator code is filled in automatically with requests.



Switch on the function

6 digit password

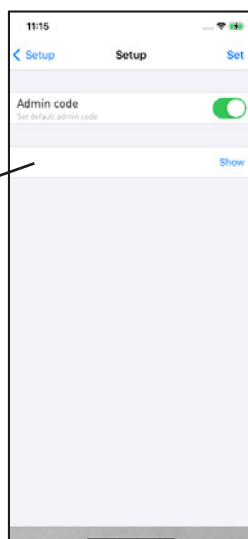
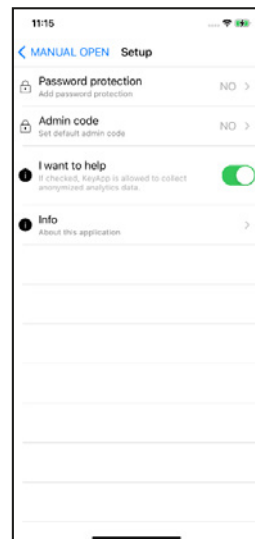

Fig. 1

Fig. 2

5.9.3 I want to help

With this function, you send anonymised data to BURG-WÄCHTER and thus help to improve the app.



Switch on the function

Fig. 1

5.9.4 Info

In this menu, important information for use of the app can be provided.

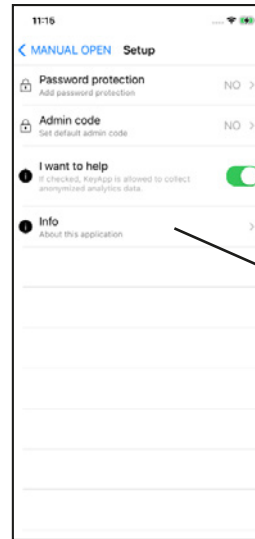

Open the menu

Fig. 1



Fig. 2

Version info:



Fig. 1

Licence provisions:



Fig. 1

Imprint

The copyright for these operating instructions are held exclusively by BURG-WÄCHTER KG.

Any reproduction, even into digital storage media requires the written consent of BURG-WÄCHTER KG. Reprinting, even excerpts, is forbidden.

Subject to errors and technical changes.

© Copyright by BURG-WÄCHTER KG, Wetter (Germany)

Data protection regulations

You are being forwarded to our homepage:
<https://www.burg.biz/datenschutz/secuentry-apps/>

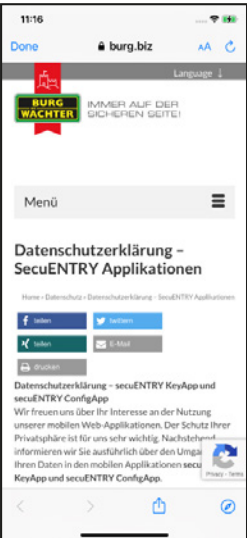

Fig. 1



secuENTRY KeyApp - iOS

BURG-WÄCHTER KG

Altenhofer Weg 15
58300 Wetter
Germany

www.burg.biz

BURG-WÄCHTER UK LTD

Eurocam Technology Park
Chase Way, Bradford, West Yorkshire
England BD5 8 HW

www.burg.biz

BA Operating instructions secuENTRY KeyApp iOS hbg 050122

www.burg.biz