

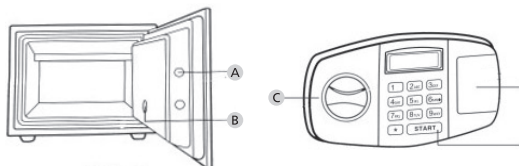

Structure



Illustrations

- A Bolts
- B Reset-Button
- C Knob (Master Key)
- D Battery cover
- E Start button

Dear customer,
Thank you for deciding for the FireProtoc FP 43 E safe manufactured by BURG-WÄCHTER. Beside the electronic lock, this safe has an integrated mechanical emergency lock mechanism.
Important: Please read the entire User Manual before you start programming.

We hope you enjoy your new safe system.
Your BURG-WÄCHTER KG

Important notes

Please take care that the codes and the code carrier. Do not fall into the wrong hands. Therefore, store the codes and code carrier at a safe location so that these can only be accessed by authorised persons. In case you lose a code or code carrier, the lock must be converted to a new code / code carrier, or replaced.

- The factory code must be changed as soon as the lock is commissioned.
- Simple codes that are easy to guess (e. g. 1, 2, 3, 4, 5, 6) must not be used.
- Personal data (e. g. birthday) or other data that may be concluded with knowledge of the code owner must not be used as code.
- After changing the code, the lock must be checked several times with the safety door opened.

Attention: Any changes of the administrator code and of the user codes shall be made with the safe door opened! When the locking system has been reset to another code, this new code should be repeatedly used with the safe door opened.

Technical data

Blocking times	After 3 wrong code entries for 3 minutes
Power supply	4 x MIGNON LR6 / AA / ALKALINE
Permissible ambient conditions (lock)	-15°C to + 50°C up to 95 % rel. air humidity (noncondensing)
Certified protection against fire #2007-0881 CNCF	1 hour by max 1.030° C
Measured in-cabin-temperature:	< 160° C

Initial setup

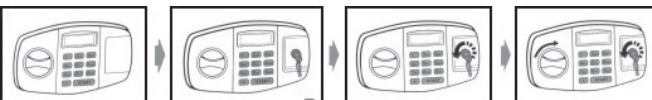

- Upon first receipt open with standard code 1-2-3-4-5-6 or if lost key, open the door with the emergency key. In order to do that, remove the battery cover, insert the emergency key and turn it counter clockwise
- Turn the knob clockwise
- Open the door
- Remove the emergency key and store it in a safe place.
- Insert the batteries.
- Set the user code

Opening with user code

- Press the „Start button“, the display shows „----“
- Input your user code. If correct the lock will unlock and the green LED will light up.
- Turn the knob clockwise
- Open the door

Programming of user code

- With the door open press the „Start button“, the display shows „----“
- Input the new 6 digit code
- Press the „Reset button“
- The display shows „USER-IN“ to indicate the successful programming of the user code

Programming of general code

- With the door open press the „Reset button“, the display shows „----“
- Press the „Start button“
- Input the new 6 digit code
- The display shows „SUPER-IN“ to indicate the successful programming of the general code

Closing the door

- Close the door
- Turn the knob counter clockwise

Battery change

- Remove the battery cover
- Take out the old batteries
- Insert four new batteries with correct alignment

If the battery voltage is too low, „Lo Batt“ appears on the display. All four batteries need to be replaced in such case. If an outage occurs for more than 30 minutes you should reset and reprogramm the user code.

Guarantee

BURG-WÄCHTER products comply with the technical standards in force at the time of production and adhere to our own quality standards. The guarantee only covers defects which can be proved to have resulted from production or material defects at the time of purchase. The guarantee expires after two years; further claims are excluded.

A short description of any defects identified must be made in writing and the device returned to the place it was bought, together with the original packaging. After the device has been tested, and within an appropriate period of time, the guarantor will decide whether or not to repair or exchange the item.

Any defects or damage which may have resulted from transport, inappropriate or improper use, wear and tear etc. are not included in the guarantee. The battery is not included in the guarantee

Disposal

Dear Customer,
Please help us avoid unnecessary waste. Should you intend to dispose of this device at any time, please remember that many components of this device contain valuable materials, which can be recycled.



Please be aware that electrical and electronic equipment and batteries shall not be disposed of as household waste, but rather collected separately. Please obtain information on the collecting points for electrical waste from the responsible authority of your municipality.



BURG-WÄCHTER KG hereby declares that this device complies with Directive 2014/30/EU, (EMC) 2011/65/EU (RoHS) and (2014/35/EU).

The full text of the EU Declaration of Conformity can be found on www.burg.biz.

Subject to technical changes without notice. Errors excepted.